

Equipped with adjuster feet SERIES

These casters are widely used for transporting machinery and equipment, appliance and furniture, etc. Articles can be easily moved and casters can be firmly fixed using the adjuster.

AF TYPE



Swivel

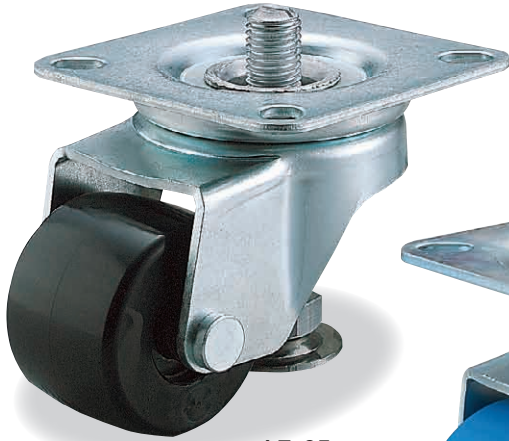

Plate type



Double Bearing

Double bearing



AF-65



AF-75

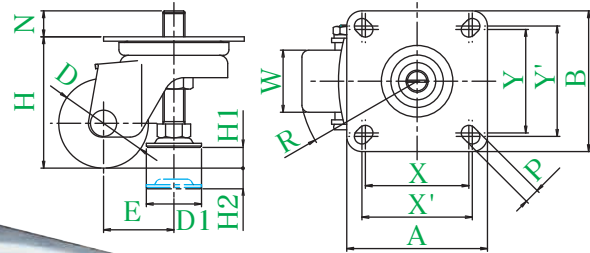

● Description of product number

AF - 65

Equipped with adjuster feet
Wheel diameter

Bracket = Trivalent unichrome coating

Product number	Wheels													
		Wheel diameter D (mm)	Wheel width W (mm)	Mounting height H (mm)	Mounting base A × B (mm)	Mounting dimensions X × Y (X' × Y') (mm)	Hole diameter P (mm)	Eccentricity E (mm)	Turning radius R (mm)	Outer diameter of adjuster feet D1 (mm)	Amount of adjustment H1 (mm) H2 (mm)	Allowance load daN (kgf)	Wheel weight (g)	
AF-50	Reinforced nylon wheel (including B)	50	45	74	102 × 102	80 × 80 (75 × 75)	11	46	73	40	15	15	250(255.0)	1190
AF-65	Reinforced nylon wheel (including B)	65	45	95	102 × 102	80 × 80 (75 × 75)	11	51	84	40	15	15	250(255.0)	1320
AF-75	MC nylon wheel (including B)	75	45	120	140 × 140	115 × 115 (105 × 105)	11.5	56	95	40	15	15	300(306.0)	2500
AF-100	MC nylon wheel (including B)	100	45	145	140 × 140	115 × 115 (105 × 105)	11.5	65	116	40	15	15	300(306.0)	2800

Wheel in use

Refer to P165 for detailed specifications.



Reinforced nylon wheel (including B)



MC nylon wheel (including B)