

Model LM-MG (Stainless Steel Type)

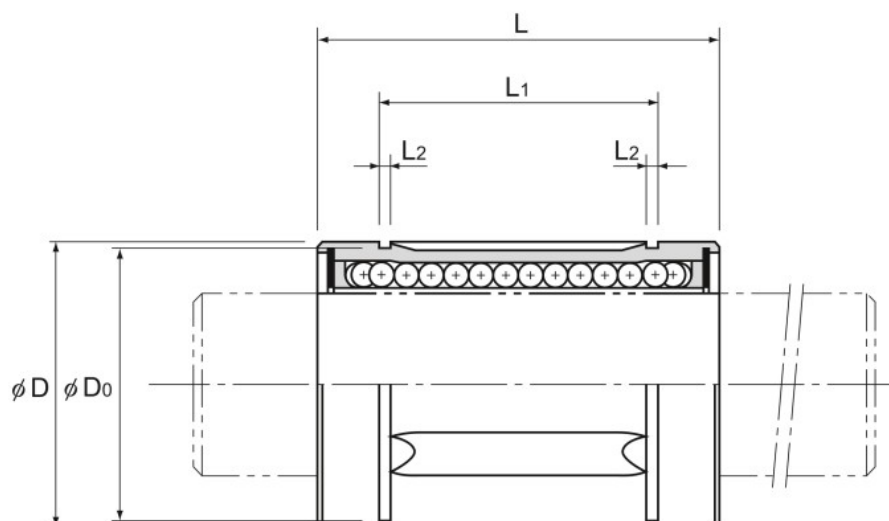

Model No.			Ball rows	Main						
Standard type	Clearance-adjustable type	Open type		Inscribed bore diameter		Outer diameter		Length		
				dr	Tolerance		D	Tolerance High/Precision	L	Tolerance
LM 3M	—	—	4	3	0	0	7	0	10	0
LM 4M	—	—	4	4			8		12	
LM 5M	—	—	4	5			10		15	
* LM 6MG	LM 6MG-AJ	—	4	6	0	0	12	0	19	0
* LM 8SMG	LM 8SMG-AJ	—	4	8			15		17	
* LM 8MG	* LM 8MG-AJ	—	4	8			15		24	
* LM 10MG	* LM 10MG-AJ	—	4	10			19		29	
* LM 12MG	* LM 12MG-AJ	—	4	12			21		30	
* LM 13MG	* LM 13MG-AJ	* LM13MGA-OP	4	13			23		32	
* LM 16MG	* LM 16MG-AJ	* LM16MGA-OP	4	16	28	37				
* LM 20MG	* LM 20MG-AJ	* LM20MGA-OP	5	20	0	0	32	0	42	0
* LM 25MG	* LM 25MG-AJ	* LM25MGA-OP	5	25			40		59	
* LM 30MG	* LM 30MG-AJ	* LM30MGA-OP	6	30			45		64	
* LM 35MG	* LM 35MG-AJ	* LM35MGA-OP	6	35	0	0	52	0	70	0
* LM 40MG	* LM 40MG-AJ	* LM40MGA-OP	6	40			60		80	

Note) Since this model contains a synthetic resin retainer, do not use it at temperature exceeding 80°C.

If the ambient temperature exceeds 80°C, use the type equipped with a metal retainer and indicate "A" at the end of the model number.

(For those marked with * in the table, metal retainers are available. Only metal retainer is available for open type.)

(Metal retainer types of models LM6MG, 8SMG and 8MG each have 3 rows of balls.)

(Example) LM30MG A

High temperature symbol

If requiring a type equipped with a seal, indicate it when placing an order. (seal heat resistance: 80°C.)

(Example) LM30MG UU

Seal attached on both ends of the nut

For the clearance-adjustable type (-AJ) and open type (-OP), the inscribed bore diameter tolerance, the outer diameter tolerance, and the eccentricity indicate the values before the division of the nut.