

# SOCKET SET SCREW

(F21, F22 & F23 SERIES)

GLOBAL STANDARD COMPONENTS



Assembly

05/14/97

## NOTES & SPECIFICATIONS:

ANSI B18.3.6M  
CLASS 45H  
See individual point styles  
for applicable DIN and ISO  
specifications  
(See next page)

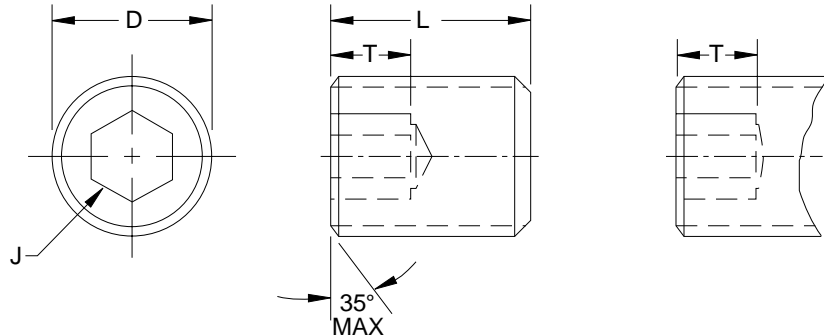

NAAMS CODE FLAT POINT STYLE	NAAMS CODE CONE POINT STYLE	NAAMS CODE CUP POINT (TYPE 1) STYLE	D NOMINAL SIZE OF BASIC SCREW $\phi$ x PITCH	J HEXAGON SOCKET SIZE NOM.	L NOMINAL SCREW LENGTHS	T FOR CUP AND FLAT POINTS MIN
F210503	F220503	F230503			3	1.2
F210504	F220504	F230504			4	2.0
F210505	F220505	F230505	5 x 0.8	2.5	5	2.7
F210506	F220506	F230506			6	2.7
F210508	F220508	F230508			8	2.7
F210604	F220604	F230604			4	1.8
F210605	F220605	F230605	6 x 1	3	5	2.5
F210606	F220606	F230606			6	3.0
F210608	F220608	F230608			8	3.0
F210805	F220805	F230805			5	1.8
F210806	F220806	F230806	8 x 1.25	4	6	2.5
F210808	F220808	F230808			8	4.0
F210810	F220810	F230810			10	4.0
F211006	F221006	F231006			6	2.0
F211008	F221008	F231008	10 x 1.5	5	8	3.6
F211010	F221010	F231010			10	5.0
F211012	F221012	F231012			12	5.0
F211208	F221208	F231208			8	3.0
F211210	F221210	F231210	12 x 1.75	6	10	4.5
F211212	F221212	F231212			12	6.0
F211216	F221216	F231216			16	6.0
F211610	F221610	F231610			10	3.0
F211612	F221612	F231612	16 x 2	8	12	4.8
F211616	F221616	F231616			16	8.0
F211620	F221620	F231620			20	8.0
F212012	F222012	F232012			12	-
F212016	F222016	F232016	20 x 2.5	10	16	6.0
F212020	F222020	F232020			20	9.0
F212025	F222025	F232025			25	10.0
F212416	F222416	F232416			16	5.0
F212420	F222420	F232420			20	8.0
F212425	F222425	F232425	24 x 3	12	25	12.0
F212430	F222430	F232430			30	12.0

A

B