

# AS□□□1F-T Series

## Construction

### Elbow type

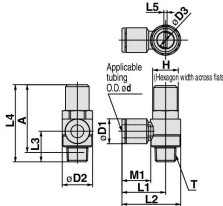

### Metric Size

Model	d	T	H	D1	D2	D3	L1	L2	L3	L4	L5	A	M1	Weight (g)
AS12□1F-M5-23T	3.2		8.4				8.4	17.3	22.1	12.3			12.7	10
AS12□1F-M5-04T	4	M5×0.8	9.3	8	9.3	9.6	4.5	17.3	22.1	12.3			13.5	10
AS12□1F-M5-06T	6		11.6				18.1	22.9	11.7				13.5	10
AS22□1F-01-23ST	3.2		8.4										12.7	20
AS22□1F-01-04ST	4		9.3				20.4	27.5					13.5	21
AS22□1F-01-06ST	6	R1/8	12	11.6	14.2	7		25.3	32.4	13.4			18.5	23
AS22□1F-01-08ST	8		15.2				33.1	40.2	15.3				21	25
AS22□1F-01-10ST	10		18.5										16	40
AS22□1F-02-04ST	4		10.4				25.2	34.4					17	40
AS22□1F-02-06ST	6		15.2				27.2	36.4					18.5	42
AS22□1F-02-08ST	8	R1/4	17	18.5	17	18.5		37.3	44.5	18.3			21	44
AS22□1F-02-10ST	10		18.5										17	73
AS22□1F-02-06ST	6		12.8				29.5	41					18.5	76
AS22□1F-02-08ST	8		15.2				31.8	43.3					21	80
AS22□1F-02-10ST	10	R1/4	19	23	9.5			51.8	43.3				22	82
AS22□1F-02-12ST	12		20.9					32.8	44.3				17	77
AS22□1F-03-06ST	6		12.8				27.8	39.3					18.5	79
AS22□1F-03-08ST	8		15.2				29.5	41					21	81
AS22□1F-03-10ST	10	R3/8	19	23	9.5			32.8	44.3		19.8	52.6	1.5	47.4
AS22□1F-03-12ST	12		20.9					33.6	47.9				21	141
AS22□1F-04-10ST	10		18.5				35.2	49.5					22	142
AS22□1F-04-12ST	12	R1/2	24	20.9	28.6	12		49.5	24.5	62.9	1.5	55.8		

\* Reference dimensions of M5 x 0.8, R threads after installation.

### Inch Size

Model	d	T	H	D1	D2	D3	L1	L2	L3	L4	L5	A	M1	Weight (g)
AS12□1F-U10/32-01T	1/8"		8.4										12.7	10
AS12□1F-U10/32-03T	3/32"		9.3				17.3	22.1	12.3				12.7	10
AS12□1F-U10/32-05T	3/16"	10-32UNF	8	11.4	9.6	4.5	21.3	26.1		31	0.7	27.4	16.5	10
AS12□1F-U10/32-07T	1/4"		12				18.3	23.1	11.7				13.5	10
AS22□1F-N01-01ST	1/8"		8.4				20.4	27.5					12.7	20
AS22□1F-N01-03ST	3/32"		9.3										13.5	21
AS22□1F-N01-05ST	3/16"	NPT 1/8	12.7	13.2	14.2	7	24	31.1	13.4	34.7	1.5	31.6	16.5	21
AS22□1F-N01-07ST	1/4"		13.2				23.9	31					17	23
AS22□1F-N01-09ST	5/16"		15.2				25.2	34.4					18.5	25
AS22□1F-N02-03ST	3/32"		10.4				25.2	34.4					16	40
AS22□1F-N02-05ST	3/16"		12.8				27.2	36.4					17.5	42
AS22□1F-N02-07ST	1/4"	NPT 1/4	17.5	13.2	16.5	7	25.2	34.4	17.7	40.2	1.5	34.7	17	42
AS22□1F-N02-09ST	5/16"		15.2				27.2	36.4					18.5	44
AS22□1F-N03-11ST	3/8"		18.5				35.3	44.5	18.3				21	44
AS22□1F-N02-07ST	1/4"		13.2				27.8	39.3					17	73
AS22□1F-N02-09ST	5/16"	NPT 1/4	19	15.2	23	9.5	29.5	41	21.3	54.8	1.5	49.3	18.5	76
AS22□1F-N03-07ST	3/8"		17.9				31.8	43.3					21	80
AS22□1F-N03-09ST	5/16"	NPT 3/8	19	15.2	23	9.5	29.5	41	19.8	52.6	1.5	47.4	18.5	79
AS22□1F-N03-11ST	3/8"		17.9				31.8	43.3					21	81
AS22□1F-N04-11ST	3/8"		17.9				33.6	47.9					21	141
AS22□1F-N04-13ST	1/2"	NPT 1/2	23.8	21.7	28.6	12	35.2	49.5	24.5	62.9	1.5	55.8	22	142

\* Reference dimensions of 10-32 UNF and NPT threads after installation.

## Dimensions

### Universal type

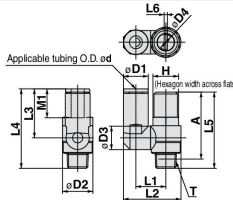

### Metric Size

Model	d	T	H	D1	D2	D3	D4	L1	L2	L3	L4	L5	L6	A	M1	Weight (g)
AS13□1F-M5-23T	3.2		8.4					19.8	17.5	28.7				12.7	10	
AS13□1F-M5-04T	4	M5×0.8	9.3	8	9.3	9.6	4.5	10.8	20.3	28.7	31	0.7	27.4	12.7	10	
AS13□1F-M5-06T	6		11.6					21.4	20.6	31.8				13.5	10	
AS23□1F-01-23ST	3.2		8.4											12.7	21	
AS23□1F-01-04ST	4		9.3					24.4	17.5	30.9				13.5	22	
AS23□1F-01-06ST	6	R1/8	12	11.6	14.2	7		24.9			34.7	1.5	31.6	13.5	22	
AS23□1F-01-08ST	8		15.2				16.2	30.9	28.2	40.8				16.5	25	
AS23□1F-02-04ST	4		10.4				16.2	30.6	21.9	39.6				16	40	
AS23□1F-02-06ST	6		15.2				18.4	34	25.2	42.1				17	41	
AS23□1F-02-08ST	8	R1/4	17	18.5	12.9	7		39.7	28.2	49.5	40.2	1.5	34.7	18.5	44	
AS23□1F-02-10ST	10		18.5				18.3	35.2	28.2	45.1				21	48	
AS23□1F-02-12ST	12		20.9				20.2	36.7	31	47.9				21	48	
AS23□1F-02-06ST	6		12.8				20.6	38.5	25.2	45.6				17	73	
AS23□1F-02-08ST	8		15.2				23	39.7	28.2	49.5				18.5	76	
AS23□1F-02-10ST	10	R1/4	19	23	9.5			43.7	32.6	53.9				21	80	
AS23□1F-02-12ST	12		20.9				23	44.9	34.4	55.7				22	82	
AS23□1F-03-06ST	6		12.8				20.6	38.5	25.2	45.6				17	78	
AS23□1F-03-08ST	8		15.2				23	39.7	28.2	49.5				18.5	81	
AS23□1F-03-10ST	10	R3/8	19	23	9.5			43.7	32.6	52.4		52.6	1.5	47.4	21	85
AS23□1F-03-12ST	12		20.9				23	44.9	34.4	54.2				22	87	
AS23□1F-04-10ST	10		18.5				25.8	49.4	32.6	57.1				21	145	
AS23□1F-04-12ST	12	R1/2	24	20.9	28.6	12		26.8	52	36.3	60.8	62.9	1.5	55.8	22	147

\* Reference dimensions of M5 x 0.8, R threads after installation.

### Inch Size

Model	d	T	H	D1	D2	D3	D4	L1	L2	L3	L4	L5	L6	A	M1	Weight (g)
AS13□1F-U20/24-01T	1/8"		8.4					19.8	17.5	28.7				12.7	10	
AS13□1F-U20/24-03T	3/32"		9.3					20.3						12.7	10	
AS13□1F-U20/24-05T	3/16"	10-32UNF	8	11.4	9.6	4.5	10.8	21.3	23.3	34.5	31	0.7	27.4	16.5	10	
AS13□1F-U20/24-07T	1/4"		12					21.6	20.7	31.9				13.7	11	
AS23□1F-N01-01ST	1/8"		8.4					24.4						12.7	21	
AS23□1F-N01-03ST	3/32"		9.3					24.9						13.5	22	
AS23□1F-N01-05ST	3/16"	NPT 1/8	12.7	11.4	14	10.9	7	24	28.8	33.9	37.3	34.7	1.5	31.6	16.5	21
AS23□1F-N01-07ST	1/4"		13.2					29.9	25.6	38.2				17	23	
AS23□1F-N01-09ST	5/16"		15.2				16.2	30.9	28.2	40.8				18.5	25	
AS23□1F-N02-03ST	3/32"		10.4					30.6	21.9	39.6				16	40	
AS23□1F-N02-05ST	3/16"		12.8					31.1	23.9	41.6				16.5	41	
AS23□1F-N02-07ST	1/4"	NPT 1/4	17.5	13.2	13.9	12.9		34.2	25.6	42.5	40.2	1.5	34.7	17	44	
AS23□1F-N02-09ST	5/16"		15.2				18.3	35.2	28.2	45.1				18.5	47	
AS23□1F-N03-11ST	3/8"		18.5				20.2	38.7	31	47.9				21	48	
AS23□1F-N02-07ST	1/4"		13.2					38.7	25.6	46.9				17	73	
AS23□1F-N02-09ST	5/16"	NPT 1/4	19	15.2	23	12.9	9.5	20.8	38.7	28.2	49.5	54.8	1.5	49.3	18.5	76
AS23□1F-N03-07ST	3/8"		17.9				16.2	43.7	32.6	53.9				21	82	
AS23□1F-N03-09ST	5/16"	NPT 3/8	19	15.2	23	12.9	9.5	20.8	38.7	25.6	45.4			17	78	
AS23□1F-N03-11ST	3/8"		17.9					39.7	28.2	48	52.6	1.5	47.4	18.5	81	
AS23□1F-N03-13ST	1/2"	NPT 3/8	19	15.2	23	12.9	9.5	20.8	38.7	25.6	45.4			21	87	
AS23□1F-N04-11ST	3/8"		17.9					43.7	32.6	52.4				21	87	
AS23□1F-N04-13ST	1/2"	NPT 1/2	23.8	21.7	29	19.4	12	25.8	49.4	32.6	57.1			21	145	
AS23□1F-N04-13ST	1/2"		23.8	21.7	29	19.4	12	26.8	52	36.3	60.8	62.9	1.5	55.8	22	147

\* Reference dimensions of 10-32 UNF and NPT threads after installation.