

Dimensions

KM11

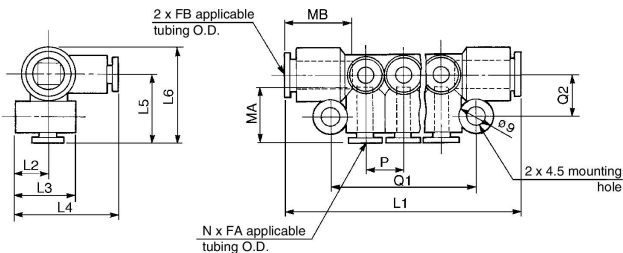

Applicable tubing O.D. (mm)		Model	N	L1	L2	L3	L4	L5	L6	P	Q1	Q2	MA	MB	Port B Min. port size	Weight (g)
FA	FB															
4	8	KM11-04-08-6	6	65	10	18	29.5	19.5	27	10.6	40	12	16	18.5	6	19
		KM11-04-08-10	10	86												26
6	10	KM11-06-10-6	6	76	10	19.5	31.5	21.5	31	13	47	13.5	17	21	7.5	29
		KM11-06-10-10	10	102												39
8	12	KM11-08-12-6	6	85	11.5	22.5	35.5	24	34.5	15.5	55	14.7	18.5	22	9	41
		KM11-08-12-10	10	116												57

KM12

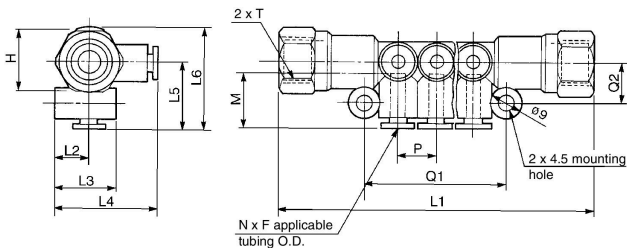

Applicable tubing O.D. F (mm)	Connection through Rc T	Model	N	H (Width across flats)	L1	L2	L3	L4	L5	L6	P	Q1	Q2	M	Port B Min. port size	Weight (g)
		KM12-04-02-10	10	110							61.5				72	
6	1/4	KM12-06-02-6	6	99	10	19.5	31.5	21.5	31	13	47	13.5	17	7.5	81	
		KM12-06-02-10	10	125							73				91	
8	3/8	KM12-08-03-6	6	108	11.5	22.5	35.5	24	34.5	15.5	55	14.7	18.5	9	112	
		KM12-08-03-10	10	139							86					

KM13

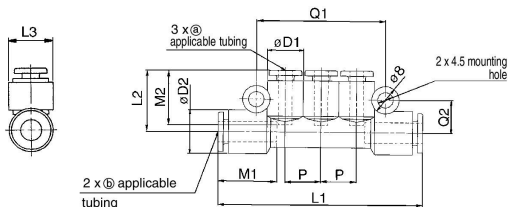

Applicable tubing O.D. (mm)		Model	øD1	øD2	L1	L2	L3	P	Q1	Q2	M1	M2	Port B Min. port size	Weight (g)
(a)	(b)													
4	6	KM13-04-06-3	10.4	12.8	60	18	13	10.4	38.2	9.9	17	16	4.5	11
	8	KM13-04-08-3											15.2	63.5
6	8	KM13-06-08-3	12.8	15.2	70.5	20	15.5	12.8	45.4	11.1	18.5	17	6	16
	10	KM13-06-10-3											18.5	74.5
8	10	KM13-08-10-3	15.2	18.5	81.5	22.5	19	15.2	52.6	12.8	21	18.5	7.5	26

[Click here for applicable color caps.](#)

KQ2
KQB2
KS
KX
KM
KF
M
H/DL
L/LL
KC
KK
KK130
DM
KDM
KB
KR
KA
KQG2
KG
KFG2
MS
KKA
KP
LQ
MQR
T
IDK