

Torque Handles

24710.0020



Product Description

Torque handles are used wherever a limitation of the exerted hand force is required. The handle, similar to a knurled nut / knurled thumb screw, with integrated torque mechanism allows a defined torque limit during tightening. Reaching the torque results in an "over-locking". For releasing the torque is transmitted indefinitely. These handles combine the functionality of a ratchet wrench with the modern and ergonomic design of a knurled nut / knurled thumb screw.

Material

Cap

- Thermoplastic PA 6, light grey, similar to RAL 7035

Torque mechanism

- Steel, hardened

Handle

- Aluminium, black anodised

Inner part

- Steel, blackened

Screw

- Steel, blackened

More information

Further products

- Three-Lobed Torque Handles

Drawing

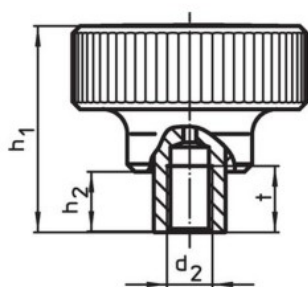

picture 1

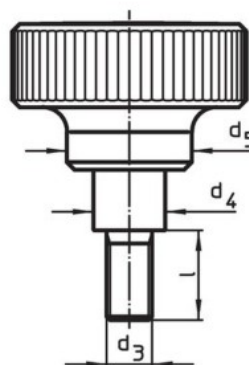
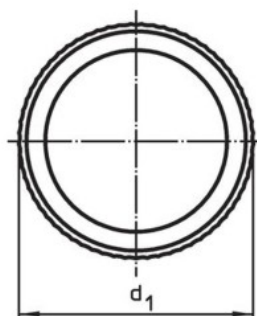

picture 2

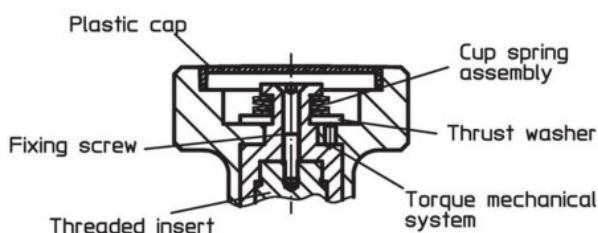

Order information

| Dimensions | | | | | | | max. [°C] | Tightening torque +/- 10% max. [Nm] | [g] | Art. No. |
|--------------------------------|----------------|----------------|----------------|----------------|----------------|---|--------------|--|-----|------------|
| d ₁ | d ₂ | d ₄ | d ₅ | h ₁ | h ₂ | t | | | | |
| with female thread – picture 1 | | | | | | | | | | |
| 34 | M3 | 10 | 21 | 37.5 | 9.5 | 7 | 100 | 1 | 48 | 24710.0020 |