

Controller Series

Throttle (Needle) Valve Brass

KJNC Elbow

RoHS compliant

Chart P.481

FITTING

CONTROLLER

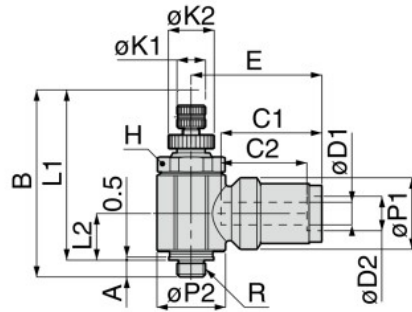

Metric thread type

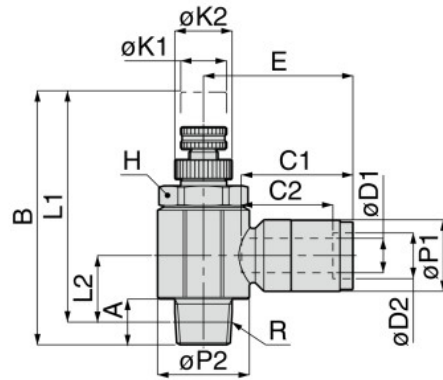

Taper pipe thread type

Unit : mm

Model code	Tube O.D. $\phi D1$	Tube O.D. $\phi D2$	R	A	B		L1		L2	E	C1	C2	$\phi P1$	$\phi P2$	$\phi K1$	$\phi K2$	Hex. H	Weight (g)
					max.	min.	max.	min.										
KJNC4-M5-□	4	6	M5×0.8	3	32.7	30	29.7	27	8.1	22.6	17.6	15	12.5	12	5	8	11	26.2
KJNC4-01-□			R1/8	8	44.4	38.3	40.4	34.3	11.6	24.8				16	8	10	14	44.4
KJNC6-M5-□	6	8	M5×0.8	3	32.7	30	29.7	27	8.1	24.1	19.5	16	12.5	12	5	8	11	26.6
KJNC6-01-□			R1/8	8	44.4	38.3	40.4	34.3	11.6	26.1				16	8	10	14	44.7
KJNC6-02-□			R1/4	11.1	53.6	46.8	47.6	40.8	15	27.6				19	10	13	17	71.5
KJNC6-03-□			R3/8	12.1	59.5	51.5	53.1	45.1	16.8	29.3				22.5	12	16	21	112.4
KJNC8-01-□	8	10	R1/8	8	44.4	38.3	40.4	34.3	11.6	26.9	20.2	17	14.5	16	8	10	14	47.1
KJNC8-02-□			R1/4	11.1	53.6	46.8	47.6	40.8	15	28.4				19	10	13	17	71.7
KJNC8-03-□			R3/8	12.1	59.5	51.5	53.1	45.1	16.8	30.1				22.5	12	16	21	112.3
KJNC10-02-□	10	12	R1/4	11.1	53.6	46.8	47.6	40.8	15	31.2	23.2	19.5	18.6	19	10	13	17	85
KJNC10-03-□			R3/8	12.1	59.5	51.5	53.1	45.1	16.8	33				22.5	12	16	21	133.6
KJNC10-04-□			R1/2	13.8	63.2	56	55	47.8	17.6	35.5				27.5	13	27	193.7	
KJNC12-03-□	12	14	R3/8	12.1	59.5	51.5	53.1	45.1	16.8	36.1	26.3	23	21.6	22.5	12	16	21	139.9
KJNC12-04-□			R1/2	13.8	63.2	56	55	47.8	17.6	36.6				27.5	13	27	200.3	

※ "L1" and "L2" are reference values for height dimensions after tightening taper thread.

※ □ in Model code / Replaced with "F" (FKM), or "N" (NBR) for Seal rubber material change

479

Speed Control Series

Stainless Series

PP Series

Anti-spatter Series

Constant Flow Series

Throttle (Needle) Valve Series

Stainless Series

PP Series

Anti-spatter Series