

90 degree elbow

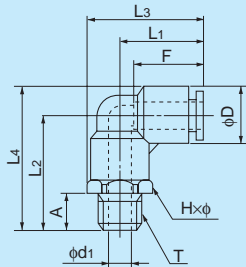

●Millimeter size type

Product number	Applicable tube outer diameter (mm)	T Thread size (R)	L ₁ (mm)	L ₂ (mm)	L ₃ (mm)	L ₄ (mm)	A (mm)	F Tube insertion length (mm)	H×φ Width across flat (mm)	D (mm)	d ₁ (mm)	Min. inner diameter (mm)	Effective cross-sectional area (mm ²)	Weight (g)
EL4-R1/8-C1	4	R1/8	17.7	23.7	23.2	28.6	9.0	14	10.0×11.0	10.0	5.0	3.0	4.0	2.0
EL4-R1/4-C1	4	R1/4	17.7	27.7	25.4	32.6	12.0	14	14.0×15.4	10.0	7.0	3.0	4.0	3.0
EL6-R1/8-C1	6	R1/8	18.9	26.2	25.4	32.5	9.0	15	12.0×13.0	13.0	4.5	4.5	12.0	4.0
EL6-R1/4-C1	6	R1/4	18.9	30.2	26.6	36.5	12.0	15	14.0×15.4	13.0	7.0	4.5	12.0	4.0
EL8-R1/8-C1	8	R1/8	21.1	29.2	28.8	36.5	9.0	16	14.0×15.4	15.0	6.0	6.0	18.5	5.0
EL8-R1/4-C1	8	R1/4	21.1	31.2	28.8	38.5	12.0	16	14.0×15.4	15.0	6.5	6.5	23.0	6.0
EL10-R1/4-C1	10	R1/4	25.0	37.2	34.3	46.0	12.0	19	17.0×18.5	18.0	8.0	8.0	34.5	9.0
EL10-R3/8-C1	10	R3/8	25.0	37.2	34.3	46.0	14.0	19	17.0×18.5	18.0	9.0	8.0	37.0	11.0
EL12-R3/8-C1	12	R3/8	26.7	38.7	37.2	48.8	14.0	20	19.0×21.0	20.5	10.0	10.0	43.0	13.0
EL12-R1/2-C1	12	R1/2	26.7	41.7	38.7	51.8	16.0	20	22.0×24.0	20.5	12.0	9.5	43.0	15.0

EL6-N1/8-C1	6	NPT1/8	18.9	26.2	25.4	32.5	9.0	15	12.0×13.0	13.0	4.5	4.5	12.0	4.0
EL6-N1/4-C1	6	NPT1/4	18.9	30.2	26.6	36.5	12.0	15	14.0×15.4	13.0	7.0	4.5	12.0	4.0

●Inch size type

Product number	Applicable tube outer diameter (inch)	T Thread size (R)	L ₁ (mm)	L ₂ (mm)	L ₃ (mm)	L ₄ (mm)	A (mm)	F Tube insertion length (mm)	H×φ Width across flat (mm)	D (mm)	d ₁ (mm)	Min. inner diameter (mm)	Effective cross-sectional area (mm ²)	Weight (g)
EL1/4-R1/8-C1	1/4	R1/8	19.9	26.2	26.4	32.5	9.0	16	12.0×13.0	13.0	4.5	4.5	13.0	4.0
EL1/4-R1/4-C1	1/4	R1/4	19.9	30.2	27.6	36.5	12.0	16	14.0×15.4	13.0	7.0	4.5	13.0	4.0
EL3/8-R1/4-C1	3/8	R1/4	25.8	37.2	35.1	46.0	12.0	20	17.0×18.5	18.0	8.0	8.0	30.0	9.0
EL3/8-R3/8-C1	3/8	R3/8	25.8	37.2	35.1	46.0	14.0	20	17.0×18.5	18.0	9.0	8.0	32.0	11.0
EL1/2-R3/8-C1	1/2	R3/8	28.7	39.0	39.2	49.6	14.0	23	19.0×21.0	21.5	10.0	10.0	53.0	13.0
EL1/2-R1/2-C1	1/2	R1/2	28.7	42.0	40.7	52.6	16.0	23	22.0×24.0	21.5	12.0	9.5	55.5	15.0

Tee

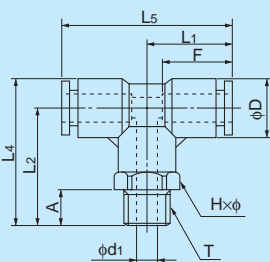

●Millimeter size type

Product number	Applicable tube outer diameter (mm)	T Thread size (R)	L ₁ (mm)	L ₂ (mm)	L ₄ (mm)	L ₅ (mm)	A (mm)	F Tube insertion length (mm)	H×φ Width across flat (mm)	D (mm)	d ₁ (mm)	Min. inner diameter (mm)	Effective cross-sectional area (mm ²)	Weight (g)
ET4-R1/8-C1	4	R1/8	17.7	23.7	28.6	35.3	9.0	14	10.0×11.0	10.0	5.0	3.0	4.0	3.0
ET4-R1/4-C1	4	R1/4	17.7	27.7	32.6	35.3	12.0	14	14.0×15.4	10.0	7.0	3.0	4.0	4.0
ET6-R1/8-C1	6	R1/8	18.9	26.2	32.5	37.9	9.0	15	12.0×13.0	13.0	4.5	4.5	12.0	5.0
ET6-R1/4-C1	6	R1/4	18.9	30.2	36.5	37.9	12.0	15	14.0×15.4	13.0	7.0	4.5	12.0	6.0
ET8-R1/8-C1	8	R1/8	21.1	29.2	36.5	42.2	9.0	16	14.0×15.4	15.0	6.0	6.0	18.5	7.0
ET8-R1/4-C1	8	R1/4	21.1	31.2	38.5	42.2	12.0	16	14.0×15.4	15.0	6.5	6.5	23.0	8.0
ET10-R1/4-C1	10	R1/4	25.0	37.2	46.0	50.0	12.0	19	17.0×18.5	18.0	8.0	8.0	34.5	14.0
ET10-R3/8-C1	10	R3/8	25.0	37.2	46.0	50.0	14.0	19	17.0×18.5	18.0	9.0	8.0	37.0	16.0
ET12-R3/8-C1	12	R3/8	26.7	38.7	48.8	53.4	14.0	20	19.0×21.0	20.5	10.0	10.0	43.0	19.0
ET12-R1/2-C1	12	R1/2	26.7	41.7	51.8	53.4	16.0	20	22.0×24.0	20.5	12.0	9.5	43.0	21.0

ET6-N1/8-C1	6	NPT1/8	18.9	26.2	32.5	37.9	9.0	15	12.0×13.0	13.0	4.5	4.5	12.0	5.0
ET6-N1/4-C1	6	NPT1/4	18.9	30.2	36.5	37.9	12.0	15	14.0×15.4	13.0	7.0	4.5	12.0	6.0

●Inch size type

Product number	Applicable tube outer diameter (inch)	T Thread size (R)	L ₁ (mm)	L ₂ (mm)	L ₄ (mm)	L ₅ (mm)	A (mm)	F Tube insertion length (mm)	H×φ Width across flat (mm)	D (mm)	d ₁ (mm)	Min. inner diameter (mm)	Effective cross-sectional area (mm ²)	Weight (g)
ET1/4-R1/8-C1	1/4	R1/8	19.9	26.2	32.5	39.8	9.0	16	12.0×13.0	13.0	4.5	4.5	13.0	5.0
ET1/4-R1/4-C1	1/4	R1/4	19.9	30.2	36.5	39.8	12.0	16	14.0×15.4	13.0	7.0	4.5	13.0	6.0
ET3/8-R1/4-C1	3/8	R1/4	25.8	37.2	46.0	51.6	12.0	20	17.0×18.5	18.0	8.0	8.0	30.0	14.0
ET3/8-R3/8-C1	3/8	R3/8	25.8	37.2	46.0	51.6	14.0	20	17.0×18.5	18.0	9.0	8.0	32.0	16.0
ET1/2-R3/8-C1	1/2	R3/8	28.7	39.0	49.6	57.5	14.0	23	19.0×21.0	21.5	10.0	10.0	53.0	19.0
ET1/2-R1/2-C1	1/2	R1/2	28.7	42.0	52.6	57.5	16.0	23	22.0×24.0	21.5	12.0	9.5	55.5	21.0

Tube

Clean tube

Processed tube

PushOne fitting

QuickSeal fitting

Clean fitting/ Chemifit

Bamboo-shoot fitting

Control switch/ Detachable series

Jig/Tool/ Accessory

Technical information

Reference