

Union tee

●Millimeter size type

Product number	d1 Applicable tubing outer diameter (mm)	d2 Applicable tubing outer diameter (inch)	L1	L5	L6	L8	F1 Tubing insertion length (mm)	F2 Tubing insertion length (mm)	P1	P2	D1	D2	W	Min. inner diameter (mm)	Effective sectional area (mm ²)	Weight (g)
EUT4	4	4	17.2	34.4	17.2	22.1	13	13	6.9	14.0	9.8	9.8	9.7	3.0	3.5	6.0
EUT4-6	4	6	17.7	35.4	18.0	22.9	13	15	6.8	17.0	9.8	12.6	12.5	3.0	2.5	8.0
EUT6	6	6	18.5	37.0	18.5	24.8	15	15	8.3	17.0	12.6	12.6	12.5	5.0	4.5	9.0
EUT6-8	6	8	19.5	39.0	20.4	26.7	15	16	8.2	19.0	12.6	14.6	14.5	5.0	15.5	11.0
EUT8	8	8	20.7	41.4	20.7	28.0	16	16	9.3	19.0	14.6	14.6	14.5	7.0	19.5	13.0
EUT8-10	8	10	21.7	43.4	24.4	31.7	16	19	9.2	22.0	14.6	17.5	17.5	7.0	21.0	18.0
EUT10	10	10	24.7	49.3	24.7	33.4	19	19	10.8	22.0	17.5	17.5	17.5	9.0	32.5	22.0
EUT10-12	10	12	25.6	51.1	26.3	35.1	19	20	10.8	24.0	17.5	20.0	20.0	9.0	27.0	26.0
EUT12	12	12	26.3	52.6	26.3	36.3	20	20	12.1	24.0	20.0	20.0	20.0	11.0	45.5	29.0
EUT16	16	16	34.9	69.8	34.9	48.9	27	27	15.9	31.7	28.0	28.0	27.5	13.0	97.0	73.0

●Inch size type

Product number	d1 Applicable tubing outer diameter (mm)	d2 Applicable tubing outer diameter (inch)	L1	L5	L6	L8	F1 Tubing insertion length (mm)	F2 Tubing insertion length (mm)	P1	P2	D1	D2	W	Min. inner diameter (mm)	Effective sectional area (mm ²)	Weight (g)
EUT1/4	1/4	1/4	18.1	36.2	18.1	24.6	15	15	8.3	17.0	13.0	13.0	12.5	5.0	12.0	9.0
EUT5/16	5/16	5/16	20.6	41.2	20.6	28.1	16	16	9.3	19.0	15.0	15.0	14.5	7.0	20.0	13.0
EUT3/8	3/8	3/8	24.4	48.8	24.4	33.4	19	19	10.8	22.0	18.0	18.0	17.5	9.0	27.0	22.0
EUT1/2	1/2	1/2	27.5	54.9	27.5	38.2	21	21	12.6	25.0	21.5	21.5	21.0	11.0	54.5	29.0

The inch size type is not plated.

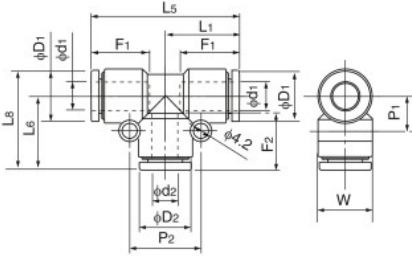

Y union

●Millimeter size type

Product number	d1 Applicable tubing outer diameter (mm)	d2 Applicable tubing outer diameter (inch)	L	L11	F1 Tubing insertion length (mm)	F2 Tubing insertion length (mm)	P3	P4	W	D1	D2	d3	Min. inner diameter (mm)	Effective sectional area (mm ²)	Weight (g)
EYB4-4	4	4	33.8	20.8	13	13	13.4	11.0	9.8	9.8	9.8	3.2	3.0	3.0	6.0
EYB4-6	4	6	34.2	20.8	13	15	13.4	11.0	12.5	9.8	12.6	3.2	3.0	2.5	8.0
EYB6-6	6	6	37.5	24.8	15	15	14.8	12.2	12.5	12.6	12.6	4.2	5.0	8.0	10.0
EYB6-8	6	8	39.2	24.8	15	16	14.8	12.2	14.5	12.6	14.6	4.2	5.0	17.0	12.0
EYB8-8	8	8	42.9	28.8	16	16	16.4	14.2	14.6	14.6	14.6	4.2	7.0	18.0	14.0
EYB8-10	8	10	44.8	28.8	16	19	16.4	14.2	17.5	14.6	17.5	4.2	7.0	22.5	19.0
EYB10-10	10	10	48.3	35.0	19	19	18.4	17.5	17.5	17.5	17.5	4.2	9.0	27.0	24.0
EYB10-12	10	12	49.4	35.0	19	20	18.4	17.5	20.0	17.5	20.0	4.2	9.0	30.0	29.0
EYB12-12	12	12	54.0	40.0	20	20	20.3	20.0	20.0	20.0	20.0	4.2	11.0	38.5	33.0

●Inch size type

Product number	d1 Applicable tubing outer diameter (mm)	d2 Applicable tubing outer diameter (inch)	L	L11	F1 Tubing insertion length (mm)	F2 Tubing insertion length (mm)	P3	P4	W	D1	D2	d3	Min. inner diameter (mm)	Effective sectional area (mm ²)	Weight (g)
EYB1/4	1/4	1/4	36.7	25.2	15	15	14.4	12.2	12.5	13.0	13.0	4.2	5.0	10.5	10.0
EYB5/16	5/16	5/16	42.7	29.2	16	16	16.3	14.2	14.5	15.0	15.0	4.2	7.0	19.5	14.0
EYB3/8	3/8	3/8	47.8	35.5	19	19	18.1	17.5	17.5	18.0	18.0	4.2	9.0	24.0	24.0
EYB1/2	1/2	1/2	55.8	42.5	21	21	20.5	21.0	21.0	21.5	21.5	4.2	11.0	46.5	33.0

The inch size type is not plated.

