

MFJ (JIS Flange Type Formed Bellows)



Pressure condition: Inside: Vacuum, Outside: Atmospheric pressure

Temperature: < 250° C

Helium leak rate: < 1×10^{-9} Pa·m³/sec

Material: Bellows: SUS316L, Flange: SUS304

Guaranteed life cycle: 10,000 cycles

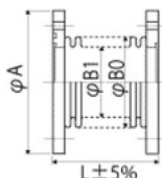

Figure: Flange both sides fixed

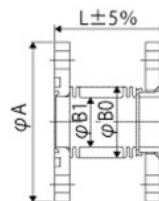

Figure: Flange one side fixed, the other side rotating

List of JIS Flange Type Formed Bellows (with Flange fixed on both sides)

| Code | Flange | φ A | B1 | B0 | t | L1 | L2 | K | Ae |
|---------|----------|-----|-------|-----|------|-----|---------|------|-------|
| MFJ-020 | JIS 20A | 80 | 22.5 | 33 | 0.15 | 60 | 54-64 | 14.7 | 6.2 |
| MFJ-025 | JIS 25A | 90 | 28.0 | 40 | 0.15 | 65 | 57-70 | 10.8 | 9.2 |
| MFJ-040 | JIS 40A | 105 | 42.7 | 58 | 0.15 | 90 | 74-100 | 5.9 | 20.1 |
| MFJ-050 | JIS 50A | 120 | 49.5 | 65 | 0.15 | 105 | 85-118 | 5.9 | 26.1 |
| MFJ-065 | JIS 65A | 145 | 61.0 | 80 | 0.15 | 110 | 83-128 | 4.9 | 39.5 |
| MFJ-080 | JIS 80A | 160 | 77.0 | 95 | 0.15 | 110 | 89-124 | 6.9 | 58.5 |
| MFJ-100 | JIS 100A | 185 | 105.5 | 125 | 0.15 | 110 | 88-124 | 8.8 | 105.2 |
| MFJ-125 | JIS 125A | 210 | 134.0 | 153 | 0.15 | 100 | 82-112 | 10.8 | 162.4 |
| MFJ-150 | JIS 150A | 235 | 156.5 | 176 | 0.15 | 100 | 82-112 | 14.7 | 217.9 |
| MFJ-200 | JIS 200A | 300 | 204.0 | 240 | 0.3 | 125 | 145-105 | 14.7 | 387.1 |
| MFJ-250 | JIS 250A | 350 | 254.0 | 290 | 0.3 | 125 | 140-102 | 21.9 | 581.1 |

List of JIS Flange Type Formed Bellows (with Flange fixed on one side)

| Code | Flange | φ A | B1 | B0 | t | L1 | L2 | K | Ae |
|-----------|----------|-----|-------|-----|------|-----|--------|------|-------|
| MFJ-020-R | JIS 20A | 80 | 22.5 | 33 | 0.15 | 60 | 64-56 | 9.2 | 6.1 |
| MFJ-025-R | JIS 25A | 90 | 28.0 | 40 | 0.15 | 65 | 70-59 | 6.9 | 9.1 |
| MFJ-040-R | JIS 40A | 105 | 42.7 | 58 | 0.15 | 90 | 100-78 | 4.0 | 19.9 |
| MFJ-050-R | JIS 50A | 120 | 49.5 | 65 | 0.15 | 105 | 118-91 | 3.8 | 25.7 |
| MFJ-065-R | JIS 65A | 145 | 61.0 | 80 | 0.15 | 110 | 128-92 | 2.4 | 39.0 |
| MFJ-080-R | JIS 80A | 160 | 77.0 | 95 | 0.15 | 110 | 124-96 | 5.2 | 58.1 |
| MFJ-100-R | JIS 100A | 185 | 105.5 | 125 | 0.15 | 110 | 124-95 | 6.0 | 104.3 |
| MFJ-125-R | JIS 125A | 210 | 134.0 | 153 | 0.15 | 100 | 112-88 | 9.8 | 161.7 |
| MFJ-150-R | JIS 150A | 235 | 156.5 | 176 | 0.15 | 100 | 111-89 | 11.9 | 217.1 |

L1: Standard manufacturing length, L2: Operating range, K(N/mm): Spring constant, Ae(cm²): Effective area

※Please contact us for the information on length other than the standard length.



MIRAPRO

1100 Anadaira Sutama-cho Hokuto Yamanashi, Japan

Sales Department FAX 0551-42-5556 e-mail mpccom@mirapro.co.jp