

MF(Multi-fastener) Flange conforming to ISO1609 is used for error absorption and workability improvement by connecting with claw clamp. Also, by using single claw clamp, you can connect piping flange directly to vacuum chamber, and that could lead to reduction of BOM and space saving. Design and production of special shape in accordance with use environment are also available other than the catalog products.

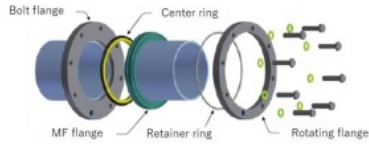

ISO MF Flange

Material:SUS304

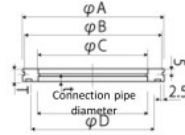

Code	Flange size	Connecting pipe	φ A	φ B	φ C	φ D	T	t	N
MCM-2063	NW63	50A (φ 60.5)	95	92	70.2	80	12	5	3-4
MCM-2080	NW80	65A (φ 76.3)	110.0	107	83.0	95	12	5	3-6
MCM-2100	NW100	90A (φ 101.6)	130	127	102.0	115	12	5	4-8
MCM-2125	NW125	100A (φ 114.3)	155	150	127.2	140	12	5	4-8
MCM-2160	NW160	125A (φ 139.8)	180	175	153.2	165	12	5	4-8
MCM-2200	NW200	200A (φ 216.3)	240	235	214.0	225	12	5	6-10
MCM-2250	NW250	250A (φ 267.4)	290	285	262.0	275	12	5	6-10

N: recommended clamp quantity