

## PSL-K Models

## Specifications

Model	Rated torque [N·m]	Rated thrust [N]	Shaft contact pressure [N/mm <sup>2</sup> ]	Hub contact pressure [N/mm <sup>2</sup> ]	Tightening torque [N·m]	Moment of inertia [kg·m <sup>2</sup> ]	Mass [kg]
PSL-K-6	5.9	1950	160	80	2	$2.5 \times 10^{-6}$	0.037
PSL-K-6.35	6.2	1950	150	80	2	$2.5 \times 10^{-6}$	0.036
PSL-K-7	6.8	1950	130	80	2	$2.5 \times 10^{-6}$	0.035
PSL-K-8	23	5900	290	160	4	$5.0 \times 10^{-6}$	0.056
PSL-K-9	26	5900	260	160	4	$5.0 \times 10^{-6}$	0.053
PSL-K-9.525	28	5900	250	130	4	$7.8 \times 10^{-6}$	0.069
PSL-K-10	29	5900	230	130	4	$7.7 \times 10^{-6}$	0.068
PSL-K-11	32	5900	210	130	4	$7.6 \times 10^{-6}$	0.065
PSL-K-12	47	7800	260	160	4	$10 \times 10^{-6}$	0.076
PSL-K-12.7	50	7800	250	140	4	$10 \times 10^{-6}$	0.073
PSL-K-14	55	7800	220	140	4	$13 \times 10^{-6}$	0.083
PSL-K-15	95	12700	290	190	8	$24 \times 10^{-6}$	0.125
PSL-K-16	100	12700	270	180	8	$27 \times 10^{-6}$	0.130
PSL-K-17	110	12700	260	170	8	$33 \times 10^{-6}$	0.145
PSL-K-18	110	12700	240	170	8	$32 \times 10^{-6}$	0.140
PSL-K-19	120	12700	230	160	8	$40 \times 10^{-6}$	0.155
PSL-K-20	130	12700	220	160	8	$39 \times 10^{-6}$	0.150
PSL-K-22	210	19000	250	170	8	$65 \times 10^{-6}$	0.210
PSL-K-24	230	19000	230	160	8	$76 \times 10^{-6}$	0.220
PSL-K-25	240	19000	220	160	8	$75 \times 10^{-6}$	0.210
PSL-K-28	380	27000	220	160	14	$203 \times 10^{-6}$	0.390
PSL-K-30	400	27000	210	150	14	$230 \times 10^{-6}$	0.400
PSL-K-32	430	27000	190	140	14	$260 \times 10^{-6}$	0.425
PSL-K-35	630	36000	210	150	14	$366 \times 10^{-6}$	0.525
PSL-K-38	680	35700	210	160	14	$426 \times 10^{-6}$	0.580
PSL-K-40	720	36000	160	120	14	$511 \times 10^{-6}$	0.599
PSL-K-42	750	35700	170	130	14	$561 \times 10^{-6}$	0.657

\* The rated torque values are those when the thrust is zero and the rated thrust values are those when the torque is zero.

## Dimensions

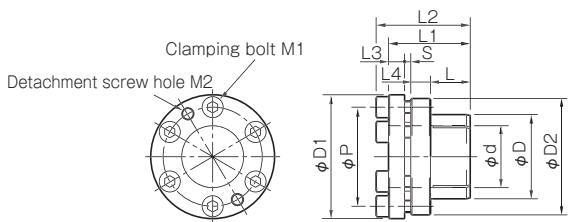

How to Place an Order

PSL-K-  
Size   
Old model ETP - K -

Model	d	D	D1	D2	P	L	L1	L2	L3	L4	S	M1	M2
PSL-K-6	6	12	25	23	17	10	20	24	3.5	5	1.5	2-M4 × 8	2-M4
PSL-K-6.35	6.35	12	25	23	17	10	20	24	3.5	5	1.5	2-M4 × 8	2-M4
PSL-K-7	7	12	25	23	17	10	20	24	3.5	5	1.5	2-M4 × 8	2-M4
PSL-K-8	8	15	28	26	20	12	24	28	5	5	2	3-M4 × 10	3-M4
PSL-K-9	9	15	28	26	20	12	24	28	5	5	2	3-M4 × 10	3-M4
PSL-K-9.525	9.525	18	31	29	23	12	24	28	5	5	2	3-M4 × 10	3-M4
PSL-K-10	10	18	31	29	23	12	24	28	5	5	2	3-M4 × 10	3-M4
PSL-K-11	11	18	31	29	23	12	24	28	5	5	2	3-M4 × 10	3-M4
PSL-K-12	12	20	33	31	25	12	24	28	5	5	2	4-M4 × 10	2-M4
PSL-K-12.7	12.7	20	33	31	25	12	24	28	5	5	2	4-M4 × 10	2-M4
PSL-K-14	14	22	35	33	27	12	24	28	5	5	2	4-M4 × 10	2-M4
PSL-K-15	15	23	39	36	29	14	29	34	6	7	2	4-M5 × 12	2-M5
PSL-K-16	16	24	40	37	30	14	29	34	6	7	2	4-M5 × 12	2-M5
PSL-K-17	17	26	42	39	32	14	29	34	6	7	2	4-M5 × 12	2-M5
PSL-K-18	18	26	42	39	32	14	29	34	6	7	2	4-M5 × 12	2-M5
PSL-K-19	19	28	44	41	34	14	29	34	6	7	2	4-M5 × 12	2-M5
PSL-K-20	20	28	44	41	34	14	29	34	6	7	2	4-M5 × 12	2-M5
PSL-K-22	22	32	48	45	38	16	33	38	6.5	8	2.5	6-M5 × 14	2-M5
PSL-K-24	24	34	50	47	40	16	33	38	6.5	8	2.5	6-M5 × 14	2-M5
PSL-K-25	25	34	50	47	40	16	33	38	6.5	8	2.5	6-M5 × 14	2-M5
PSL-K-28	28	39	62	59	47	20	39	45	7.5	9	2.5	6-M6 × 16	2-M6
PSL-K-30	30	41	64	61	49	20	39	45	7.5	9	2.5	6-M6 × 16	2-M6
PSL-K-32	32	43	66	63	51	20	39	45	7.5	9	2.5	6-M6 × 16	2-M6
PSL-K-35	35	47	70	67	55	22	43	49	8	10	3	8-M6 × 18	2-M6
PSL-K-38	38	50	73	70	58	22	43	49	8	10	3	8-M6 × 18	2-M6
PSL-K-40	40	53	76	73	61	22	43	49	8	10	3	8-M6 × 18	2-M6
PSL-K-42	42	55	78	75	63	22	43	49	8	10	3	8-M6 × 18	2-M6

\* L1, L2, and S are dimensions before the POSI-LOCK is mounted.

\* The nominal diameter of each bolt and tap is equal to the quantity minus the nominal diameter of the screw threads times the nominal length.