

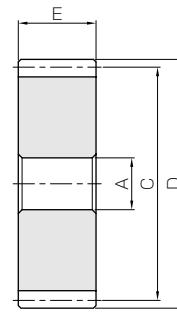

Specifications	
Precision grade	JIS grade N8 (JIS B1702-1: 1998) JIS grade 4 (JIS B1702: 1976)
Gear teeth	Standard full depth
Pressure angle	20°
Material	S45C
Heat treatment	—
Tooth hardness	(less than 194HB)

* The precision grade of J Series products is equivalent to the value shown in the table.



S5

Catalog No.	No. of teeth	Shape	Bore		Pitch dia.	Outside dia.		Face width	Web thickness	Web O.D.	Allowable torque (N·m)		Allowable torque (kgf·m)		Backlash (mm)	Weight (kg)	
			A _{H7}	B		C	D				E	(H)	(I)	Bending strength			Surface durability
SSA2-20	20	S5	12	—	40	44	20	—	—	—	46.0	2.83	4.69	0.29	0.12~0.26	0.18	
SSA2-24	24				48	52					59.8	4.24	6.09	0.43			
SSA2-25	25				50	54					63.3	4.64	6.45	0.47			
SSA2-28	28				56	60					73.9	5.89	7.54	0.60			
SSA2-30	30				60	64					81.1	6.80	8.27	0.69			
SSA2-32	32		15		—	64					68	88.4	7.78	9.01			0.79
SSA2-35	35					70					74	99.3	9.39	10.1			0.96
SSA2-36	36					72					76	103	9.96	10.5			1.02
SSA2-40	40					80					84	118	12.5	12.0			1.27
SSA2-45	45					90					94	137	16.0	13.9			1.63
SSA2-48	48	18	—	96		100	148	18.3	15.1	1.87							
SSA2-50	50			100		104	156	19.9	15.9	2.03							
SSA2-55	55			110		114	175	24.4	17.8	2.48							
SSA2-56	56			112		116	179	25.3	18.2	2.58							
SSA2-60	60			120		124	194	29.3	19.8	2.99							
SSA2-70	70			S6	70	140	144	232	40.8	23.7	4.16						
SSA2-80	80	160				164	271	54.3	27.7	5.53							
SSA2-100	100	90				200	291	72.7	29.7	7.42							
SSA2.5-20	20	S5		15		—	50	55	25	—	—	—	89.8	5.66	9.16	0.58	0.14~0.28
SSA2.5-24	24		60				65	117					8.47	11.9	0.86		
SSA2.5-25	25		62.5				67.5	124					9.26	12.6	0.94		
SSA2.5-28	28		70				75	144					11.7	14.7	1.20		
SSA2.5-30	30		75				80	159					13.6	16.2	1.39		
SSA2.5-32	32		18	—			80	85					173	15.6	17.6	1.59	
SSA2.5-35	35				87.5		92.5	194					18.8	19.8	1.92		
SSA2.5-36	36				90		95	201					20.0	20.5	2.04		
SSA2.5-40	40				100		105	230					24.9	23.5	2.54		
SSA2.5-45	45				112.5		117.5	267					31.9	27.2	3.26		
SSA2.5-48	48	22	70		120	125	289	36.7	29.5	3.74							
SSA2.5-50	50				125	130	304	40.0	31.0	4.08							
SSA2.5-55	55				137.5	142.5	341	49.1	34.8	5.01							
SSA2.5-56	56				140	145	349	51.0	35.6	5.20							
SSA2.5-60	60				150	155	379	59.1	38.6	6.03							
SSA2.5-70	70			S6	80	175	180	454	82.1	46.3	8.37						
SSA2.5-80	80	90				205	441	90.9	45.0	9.27							

[Caution on Product Characteristics]

- ① The allowable torques shown in the table are calculated values according to the assumed usage conditions. Please see Page 31 for more details.
- ② The backlash values shown in the table are the theoretical values for the backlash in the normal direction of a pair of identical gears in mesh.

[Caution on Secondary Operations]

- ① Please read "Caution on Performing Secondary Operations" (Page 32) when performing modifications and/or secondary operations for safety concerns. KHK Quick-Mod Gears, the KHK's system for quick modification of KHK stock gears is also available.
- ② Avoid performing secondary operations that narrow the tooth width as it affects precision and strength.