



SSG Ground Spur Gears



Module 2



Specifications	
Precision grade	JIS grade N7 (JIS B1702-1: 1998) * JIS grade 3 (JIS B1702: 1976)
Gear teeth	Standard full depth
Pressure angle	20°
Material	S45C
Heat treatment	Tooth surface induction hardened
Tooth hardness	50 ~ 60HRC
Face width (E)	20
Hub width (F)	16
Total length (G)	36
Screw offset (J)	8

* The precision grade of J Series products is equivalent to the value shown in the table.

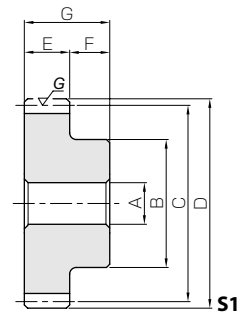

Catalog No.	No. of teeth	Shape	Bore				Hub dia.		Pitch dia.		Outside dia.		Allowable torque (N-m)		Allowable torque (kgf-m)		Backlash (mm)	Weight (kg)
			A _{H7}	B	C	D	Bending strength	Surface durability	Bending strength	Surface durability								
SSG2-14	14	S1	12	22	28	32	26.3	9.01	2.69	0.92	0.10~0.20	0.11						
SSG2-15	15			24	30	34	29.6	10.5	3.01	1.07								
SSG2-16	16			26	32	36	27.3	10.1	2.78	1.03								
SSG2-17	17			28	34	38	30.0	11.6	3.06	1.18								
SSG2-18	18			30	36	40	32.7	13.1	3.34	1.34								
SSG2-19	19			31	38	42	35.5	14.8	3.62	1.51								
SSG2-20	20		32	40	44	38.3	16.6	3.91	1.69	0.12~0.22			0.24					
SSG2-21	21		34	42	46	41.1	18.4	4.20	1.88									
SSG2-22	22		36	44	48	44.0	20.4	4.49	2.08									
SSG2-23	23		37	46	50	46.9	22.5	4.78	2.30									
SSG2-24	24	38	48	52	49.8	24.7	5.08	2.52										
SSG2-25	25	40	50	54	52.7	27.0	5.38	2.75										
SSG2-26	26	42	52	56	55.7	29.3	5.68	2.99	0.14~0.24	0.46								
SSG2-27	27	44	54	58	58.6	31.7	5.98	3.23										
SSG2-28	28	45	56	60	61.6	34.2	6.28	3.49	0.59	0.54								
SSG2-29	29	48	58	62	64.6	36.8	6.59	3.75										
SSG2-30	30	50	60	64	67.6	39.5	6.89	4.03	0.12~0.22	0.62								
SSG2-32	32	50	64	68	73.7	45.2	7.51	4.61										
SSG2-34	34	50	68	72	79.8	51.3	8.13	5.23										
SSG2-35	35	50	70	74	82.8	54.5	8.45	5.56										
SSG2-36	36	50	72	76	85.9	57.8	8.76	5.90										
SSG2-38	38	50	76	80	92.1	64.8	9.39	6.60										
SSG2-40	40	60	80	84	98.3	72.1	10.0	7.35	1.06	1.14								
SSG2-42	42	60	84	88	105	79.9	10.7	8.15										
SSG2-44	44	60	88	92	111	88.1	11.3	8.98	1.22	1.27								
SSG2-45	45	60	90	94	114	92.3	11.6	9.41										
SSG2-48	48	60	96	100	114	97.6	11.6	9.95	1.40	1.45								
SSG2-50	50	60	100	104	120	106	12.2	10.8										
SSG2-55	55	60	110	114	134	130	13.7	13.3	1.71	1.76								
SSG2-56	56	60	112	116	137	135	14.0	13.8										
SSG2-60	60	65	120	124	149	156	15.2	15.9	0.14~0.24	2.05								
SSG2-64	64	65	128	132	161	179	16.4	18.3										
SSG2-70	70	70	140	144	179	216	18.2	22.0										
SSG2-75	75	70	150	154	194	249	19.7	25.4										
SSG2-80	80	80	160	164	194	265	19.8	27.0										
SSG2-90	90	80	180	184	222	338	22.6	34.5										
SSG2-100	100	80	200	204	250	421	25.4	43.0	5.42									

[Caution on Product Characteristics]

- ① The allowable torques shown in the table are calculated values according to the assumed usage conditions. Please see Page 31 for more details.
- ② The backlash values shown in the table are the theoretical values for the backlash in the normal direction of a pair of identical gears in mesh.

[Caution on Secondary Operations]

- ① Please read "Caution on Performing Secondary Operations" (Page 32) when performing modifications and/or secondary operations for safety concerns. KHK Quick-Mod Gears, the KHK's system for quick modification of KHK stock gears is also available.
- ② Due to the gear teeth being induction hardened, no secondary operations can be performed on tooth areas including the bottom land (approx. 2 to 3 mm).