

B-1 Series Bite Type Fittings For Copper Tube

Nut KN

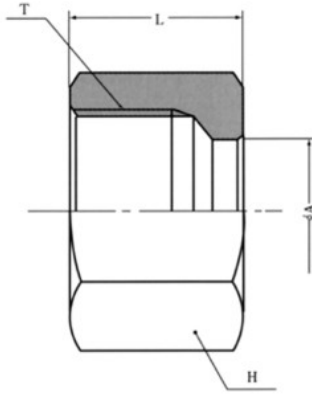

unit : mm

Designations	Tube O.D. A	Approx. L	Width Across Hex. Flats H	T	Weight (kg)
KN4-B-1	4	10	10	M8×1	0.004
KN6-B-1	6	11	12	M10×1.25	0.006
KN8-B-1	8	12	14	M12×1.25	0.008
KN10-B-1	10	12	17	M14×1.5	0.014
KN12-B-1	12	13	19	M16×1.5	0.016
KN15-B-1	15	13	23	M20×1.5	0.021
KN20-B-1	20	13.5	29	M26×1.5	0.032
KN25-B-1	25	14	36	M32×1.5	0.050

⚠ Note: Dimension might be modified due to improvement of quality and performance.

Sleeve KO

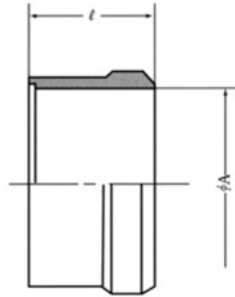

unit : mm

Designations	Tube O.D. A	l	Weight (kg)
KO4-B-1	4	7	0.001
KO6-B-1	6	7	0.001
KO8-B-1	8	7.5	0.001
KO10-B-1	10	7.5	0.001
KO12-B-1	12	7.5	0.002
KO15-B-1	15	8.5	0.003
KO20-B-1	20	8.5	0.003
KO25-B-1	25	9	0.006

⚠ Note: Dimension might be modified due to improvement of quality and performance.