

# IS Type/IS-S Type

STEEL

STAINLESS

UPWARD

Load Capacity  
40 ~ 1500kgf  
392 ~ 14700N  
88 ~ 3307lbf



Precision-machined ball transfers with exceptional endurance for heavy loads. Available in steel and stainless. Applications include refraction, curves, intersection, rotation and branches of conveyor systems. Designed to transfer heavy materials, changing direction of devices, shearing press, feeding and high damping machines.

STEEL

## IS-10

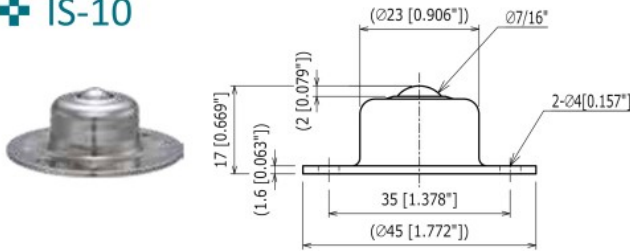

Ball Size	: $\phi 7/16''$ (11.11 mm)	Body	: SCM415
Product Weight	: 0.06 kg/ 0.13 lbs	Main Ball	: SUJ2
Load Capacity	: 40 kgf/ 392 N/ 88 lbf	Small Balls	: SUJ2
		Cap	: SPC

## IS-13

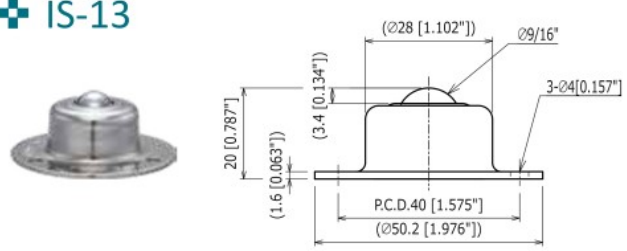

Ball Size	: $\phi 9/16''$ (14.29 mm)	Body	: SCM415
Product Weight	: 0.09 kg/ 0.2 lbs	Main Ball	: SUJ2
Load Capacity	: 50 kgf/ 490 N/ 110 lbf	Small Balls	: SUJ2
		Cap	: SPC

## IS-19

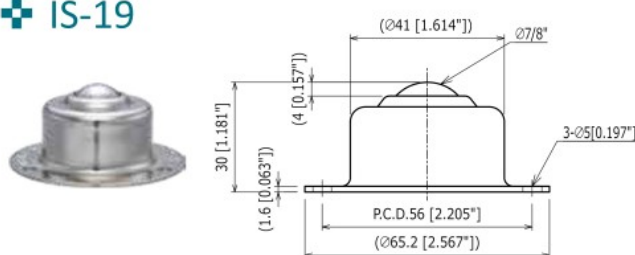

Ball Size	: $\phi 7/8''$ (22.23 mm)	Body	: SCM415
Product Weight	: 0.25 kg/ 0.55 lbs	Main Ball	: SUJ2
Load Capacity	: 100 kgf/ 980 N/ 221 lbf	Small Balls	: SUJ2
		Cap	: SPC

## IS-25

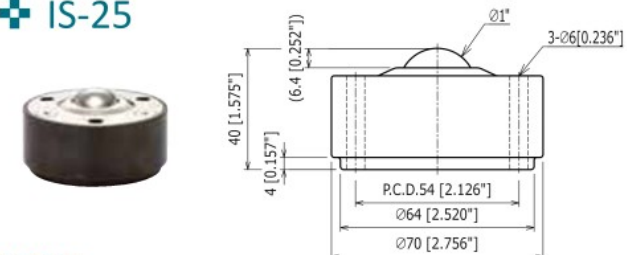

With Felt Seal

Ball Size	: $\phi 1''$ (25.4 mm)	Body	: SCM415
Product Weight	: 0.9 kg/ 2 lbs	Main Ball	: SUJ2
Load Capacity	: 150 kgf/ 1470 N/ 331 lbf	Small Balls	: SUJ2
		Cap	: SPC

## IS-38

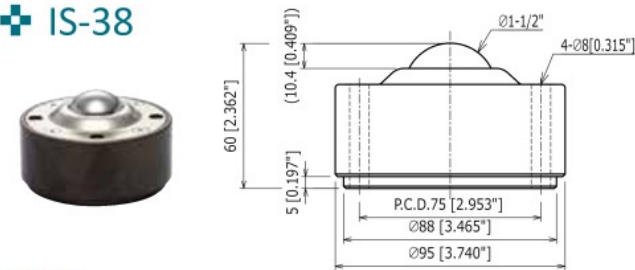

With Felt Seal

Ball Size	: $\phi 1-1/2''$ (38.1 mm)	Body	: SCM415
Product Weight	: 2.3 kg/ 5.1 lbs	Main Ball	: SUJ2
Load Capacity	: 250 kgf/ 2450 N/ 551 lbf	Small Balls	: SUJ2
		Cap	: SPC

## IS-51

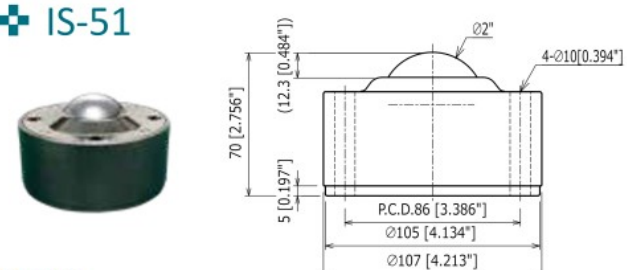

With Felt Seal

Ball Size	: $\phi 2''$ (50.8 mm)	Body	: SCM415
Product Weight	: 3.4 kg/ 7.5 lbs	Main Ball	: SUJ2
Load Capacity	: 300 kgf/ 2940 N/ 662 lbf	Small Balls	: SUJ2
		Cap	: S45C

## IS-76

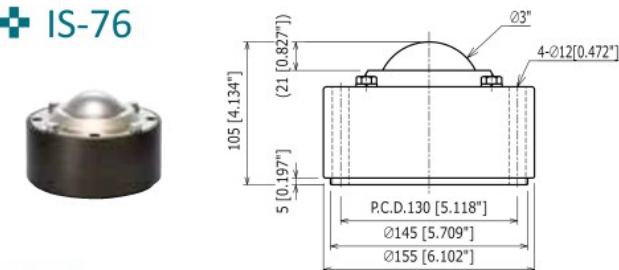

With Felt Seal

Ball Size	: $\phi 3''$ (76.2 mm)	Body	: SCM415
Product Weight	: 10.5 kg/ 23 lbs	Main Ball	: SUJ2
Load Capacity	: 450 kgf/ 4410 N/ 992 lbf	Small Balls	: SUJ2
		Cap	: S45C

## IS-100

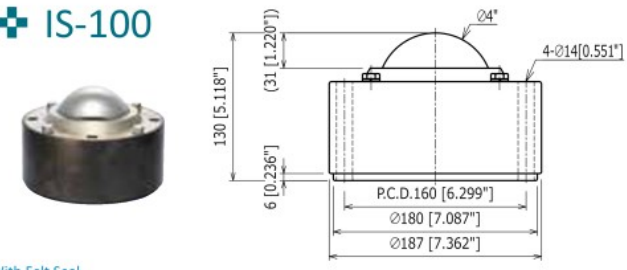

With Felt Seal

Ball Size	: $\phi 4''$ (101.6 mm)	Body	: SCM415
Product Weight	: 18.5 kg/ 41 lbs	Main Ball	: SUJ2
Load Capacity	: 1000 kgf/ 9800 N/ 2205 lbf	Small Balls	: SUJ2
		Cap	: S45C