

## 2-Bolt Flange Units

### UCFL

#### Cylindrical bore (with set screws)

$d$  12 ~ (45) mm

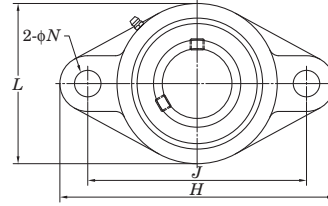
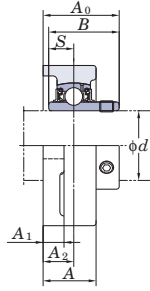

Shaft Dia. mm inch	Dimensions											Bolt Size inch mm	Standard		
	$d$	$H$	$L$	$A$	$J$	$N$	$A_1$	$A_2$	$A_0$	$B$	$S$		Unit No.	Housing No.	Bearing No.
12 15 17 20	1/2												M10	FL204	UC201 UC201-8 UC202 UC202-10 UC203 UC204-12 UC204
	5/8	4 7/16	2 3/8	1	3 35/64	15/32	7/16	19/32	1 5/16	1.220	0.500				
	3/4	113	60	25.5	90	12	11	15	33.3	31	12.7				
25	7/8												M14	FL205	UC205-14 UC205-15 UC205 UC205-16
	15/16	5 1/8	2 11/16	1 1/16	3 57/64	5/8	1/2	5/8	1 13/32	1.343	0.563				
	1	130	68	27	99	16	13	16	35.8	34.1	14.3				
30	1 1/8												M14	FL206	UC206-18 UC206 UC206-19 UC206-20
	1 3/16	5 9/16	3 9/32	1 3/16	4 39/64	15/32	1/2	45/64	1 19/32	1.500	0.626				
	1 1/4	141	83	30	117	12	13	18	40.2	38.1	15.9				
35	1 3/16												M14	FLX06	UCX06 UCX06-19 UCX06-20
	1 1/4	6 5/32	3 3/4	1 11/32	5 1/8	5/8	9/16	3/4	1 3/4	1.689	0.689				
		156	95	34	130	16	14	19	44.4	42.9	17.5				
40	1 1/4												M20	FL306	UC306
	1 5/16	7 3/32	3 17/32	1 1/4	5 9/32	29/32	19/32	45/64	1 23/32	1.693	0.669				
	1 3/8	180	90	32	134	23	15	18	44	43	17				
45	1 1/4												M14	FL207	UC207-20 UC207-21 UC207-22 UC207 UC207-23
	1 5/16	6 11/32	3 17/32	1 11/32	5 1/8	5/8	9/16	3/4	1 3/4	1.689	0.689				
	1 3/8	161	90	34	130	16	14	19	44.4	42.9	17.5				
45	1 7/16												M14	FLX07	UCX07-22 UCX07 UCX07-23
	1 3/8	6 23/32	4 1/8	1 1/2	5 43/64	5/8	9/16	53/64	2 1/32	1.937	0.748				
	1 7/16	171	105	38	144	16	14	21	51.2	49.2	19				
45	1 7/16												M20	FL307	UC307
		7 9/32	3 15/16	1 13/32	5 35/64	29/32	5/8	25/32	1 15/16	1.890	0.748				
		185	100	36	141	23	16	20	49	48	19				
45	1 1/2												M14	FL208	UC208-24 UC208-25 UC208
	1 9/16	6 7/8	3 15/16	1 13/32	5 43/64	5/8	9/16	53/64	2 1/32	1.937	0.748				
		175	100	36	144	16	14	21	51.2	49.2	19				
45	1 1/2												M14	FLX08	UCX08-24 UCX08
		7 1/16	4 3/8	1 9/16	5 53/64	5/8	9/16	55/64	2 1/16	1.937	0.748				
		179	111	40	148	16	14	22	52.2	49.2	19				
45	1 1/2												M20	FL308	UC308-24 UC308
		7 7/8	4 13/32	1 9/16	6 7/32	29/32	21/32	29/32	2 7/32	2.047	0.748				
		200	112	40	158	23	17	23	56	52	19				
45	1 5/8												M16	FL209	UC209-26 UC209-27 UC209-28 UC209
	1 11/16	7 13/32	4 1/4	1 1/2	5 53/64	3/4	19/32	55/64	2 1/16	1.937	0.748				
	1 3/4	188	108	38	148	19	15	22	52.2	49.2	19				
45	1 11/16												M14	FLX09	UCX09-27 UCX09-28 UCX09
	1 3/4	7 7/16	4 9/16	1 9/16	6 3/16	5/8	9/16	29/32	2 3/16	2.031	0.748				
		189	116	40	157	16	14	23	55.6	51.6	19				

Remarks 1. In Part No. of unit and units with covers, fitting codes follow bore diameter numbers. (See Table 10.5 in P.62.)  
 2. Part No. of applicable grease fittings are shown below.  
 A-1/4-28UNF ..... 201~210, X05~X09, 305~308  
 A-R1/8..... 211~218, X10, 309~324