

▶ Cable Connecting Receptacle

■ Plastic Hood Type

P/N : JMCR1303M □ G-D  
 ① ② ③ ④ ⑤ ⑥ ⑦

① Connector Style	CR : Cable Connecting Receptacle
② Shell Size	13, 16, 21 and 25
③ Number of Contacts	03, 04, 05, 07, 10, 16, 19, 24, 28 and 32
④ Contact Style	M : Male Contact(Pin) F : Female Contact(Socket)
⑤ Alternate Insert Position	Omit : Standard Position X, Y, Z : Alternate Insert Position
⑥ Contact Plating	Omit : Silver Plating (Standard) G : Gold Plating
⑦ Finish	D : Trivalent Chromium Treatment(Black)

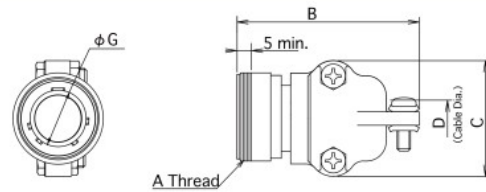

Shell Size	A	B (max.)	C(max.)	φ D	φ G <sup>+0.2</sup> <sub>-0</sub>
13	M18×1	46.5	26.5	3.0 ~ 8.0	13.0
16	M22×1	48.8	30.5	3.0 ~ 9.0	16.6
21	M26×1	51.8	34.0	8.0 ~ 12.0	20.8
25	M30×1	54.1	37.5	9.6 ~ 15.0	25.0

■ Metal Hood Type

P/N : JMCR1303M □ GM-D  
 ① ② ③ ④ ⑤ ⑥ ⑦ ⑧

① Connector Style	CR : Cable Connecting Receptacle
② Shell Size	13, 16, 21 and 25
③ Number of Contacts	03, 04, 05, 07, 10, 16, 19, 24, 28 and 32
④ Contact Style	M : Male Contact(Pin) F : Female Contact(Socket)
⑤ Alternate Insert Position	Omit : Standard Position X, Y, Z : Alternate Insert Position
⑥ Contact Plating	Omit : Silver Plating (Standard) G : Gold Plating
⑦ Hood	M : Metal Hood
⑧ Finish	D : Trivalent Chromium Treatment(Black)

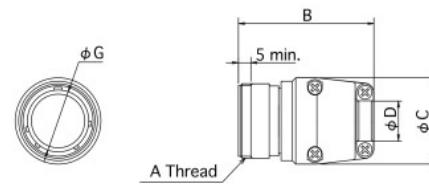

Shell Size	A	B (max.)	C (max.)	φ D	φ G <sup>+0.2</sup> <sub>-0</sub>
13	M18×1	48.5	24.0	7 ~ 8.7	13.0
16	M22×1	50.5	27.9	8 ~ 10.5	16.6
21	M26×1	52.5	32.1	10 ~ 13.0	20.8
25	M30×1	55.5	35.3	14 ~ 16.0	25.0

▶ Right Angle Cable Receptacle

■ Metal Hood Type

P/N : JMCL1303M □ GM-D  
 ① ② ③ ④ ⑤ ⑥ ⑦ ⑧

① Connector Style	CL : Right Angle Cable Receptacle
② Shell Size	13, 16, 21 and 25
③ Number of Contacts	03, 04, 05, 07, 10, 16, 19, 24, 28 and 32
④ Contact Style	M : Male Contact(Pin) F : Female Contact(Socket)
⑤ Alternate Insert Position	Omit : Standard Position X, Y, Z : Alternate Insert Position
⑥ Contact Plating	Omit : Silver Plating (Standard) G : Gold Plating
⑦ Hood	M : Metal Hood
⑧ Finish	D : Trivalent Chromium Treatment(Black)

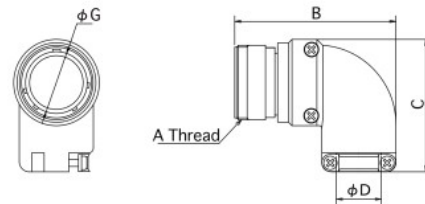

Shell Size	A	B (max.)	C (max.)	φ D	φ G <sup>+0.2</sup> <sub>-0</sub>
13	M18×1	52.5	42.5	7 ~ 8.7	13.0
16	M22×1	57.0	46.5	8 ~ 10.5	16.6
21	M26×1	60.5	50.7	10 ~ 13.0	20.8
25	M30×1	66.0	53.9	14 ~ 16.0	25.0