

# AS□□□1F-T Series

## Dimensions

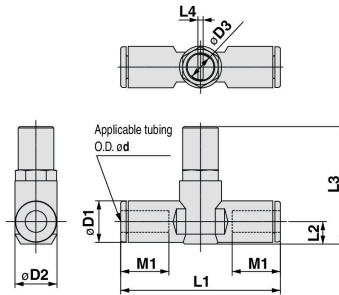

### Metric Size

Model	d	D1	D2	D3	L1	L2	L3	L4	M1	Weight(g)
AS1001F-23T	3.2	8.4	10.5	4.5	38	4.5	26	0.7	12.7	8
AS1001F-04T	4	9.3			39.2	5.2	26.6		13.5	10
AS1001F-06T	6	11.6	12.3	7	40.7	5.2	31.9	1.5	12.7	15
AS2001F-04T	4	9.3			44.8	6.3	33		13.5	16
AS2001F-06T	6	11.6	15.5	7	53.2	6.7	35.2	1.5	17	33
AS2051F-06T	8	15.2			59.8	8.1	36.5		18	36
AS3001F-06T	6	12.8	20.6	9.5	59	7.4	45	1.5	17	56
AS3001F-08T	8	15.2			64.4	8.2	45.8		18	60
AS3001F-10T	10	18.5	27.6	12	71.6	9.8	47.3	1.5	21	64
AS3001F-12T	12	20.9			76	11	48.5		22	68
AS4001F-10T	10	18.5	27.6	12	77.7	11.3	55.4	1.5	21	121
AS4001F-12T	12	20.9			82.1	11.3	56.4		22	125

### Inch Size

Model	d	D1	D2	D3	L1	L2	L3	L4	M1	Weight(g)
AS1001F-01T	1/8"	8.4	10.5	4.5	38	4.5	26	0.7	12.7	8
AS1001F-03T	5/32"	9.3			39.2	5.2	26.6		13.5	9
AS1001F-05T	3/16"	11.4	12.3	7	40.7	5.2	31.9	1.5	12.7	15
AS1001F-07T	1/4"	12			40.7	6.2	27.7		13.7	11
AS2001F-03T	5/32"	9.3	15.5	7	40.7	5.2	31.9	1.5	12.7	15
AS2001F-05T	3/16"	11.4			50	6.2	32.8		16.5	21
AS2001F-07T	1/4"	13.2	20.6	9.5	52.2	7.1	33.7	1.5	17	19
AS2051F-05T	3/16"	11.4			52.2	6.2	34.9		16.5	35
AS2051F-07T	1/4"	13.2	27.6	12	54.4	7.1	35.7	1.5	17	33
AS2051F-09T	5/16"	15.2			59.8	8.1	36.7		18	36
AS3001F-07T	1/4"	13.2	27.6	12	59	7.4	45.2	1.5	17	56
AS3001F-09T	5/16"	15.2			64.4	8.2	46		18	60
AS3001F-11T	3/8"	17.9	27.6	12	70.8	9.5	47.2	1.5	21	72
AS4001F-11T	3/8"	17.9			76.9	10.3	55.5		21	129
AS4001F-13T	1/2"	21.7	27.6	12	83.1	11.6	56.9	1.5	22	142

## Made to Order



Lubricant: Vaseline

**X12**

Ex.) AS1001F-23T-X12

Grease-free (Seal: Fluorine Coated) + Throttle Valve (Without Check Valve)

**X21**

Ex.) AS1001F-23T-X21

Note 1) Not particle-free

Throttle Valve (Without Check Valve)

**X214**

Ex.) AS1001F-23T-X214