

# CBA2 Series

**Basic** (Dimensions are common to head end lock, rod end lock and double end lock types.)

## Head end lock: CBA2B Bore size – Stroke -HN

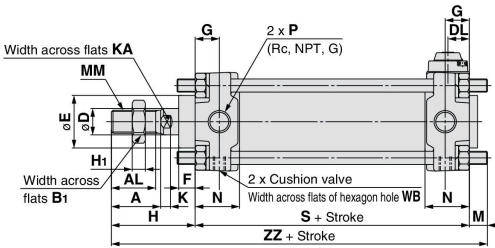

Non-locking type manual release:  
Suffix N

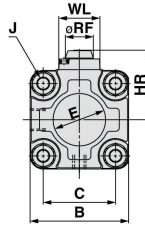

Locking type manual release:  
Suffix L

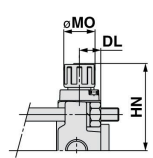

## Rod end lock: CBA2B Bore size – Stroke -RN

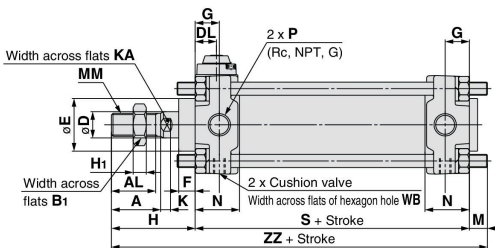

Non-locking type manual release:  
Suffix N

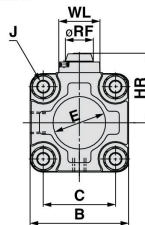

Locking type manual release:  
Suffix L

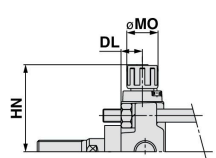

## Double end lock: CBA2B Bore size – Stroke -WN

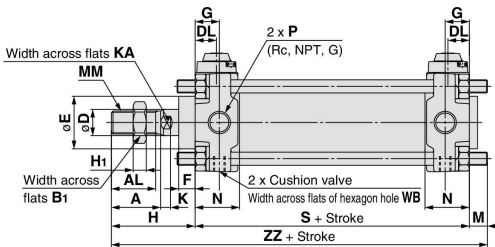

Non-locking type manual release:  
Suffix N

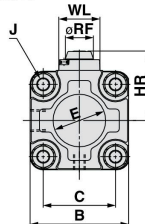

Locking type manual release:  
Suffix L

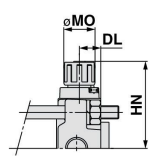

## With rod boot

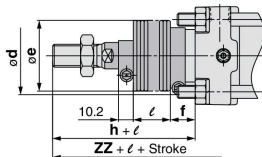

## With Rod Boot

Bore size (mm)	Stroke range (mm)	d	e	f	h	ℓ	ZZ
40	20 to 500	56	43	11.2	59	1/4 stroke	154
50	20 to 600	64	52	11.2	66	1/4 stroke	167
63	20 to 600	64	52	11.2	66	1/4 stroke	178
80	20 to 750	76	65	12.5	80	1/4 stroke	213
100	20 to 750	76	65	14	81	1/4 stroke	224

Bore size (mm)	Stroke range	A	AL	B	B <sub>1</sub>	C	D	DL	E	F	G	H	H <sub>1</sub>	HR	HN (Max.)	J	K	KA	M	MM	MO	N	P	RF	S	WB	WL	ZZ
40	Up to 500	30	27	60	22	44	16	13	32	10	15	51	8	42.3	56	M8 x 1.25	6	14	11	M14 x 1.5	19	27	1/4	17	84	2.5	25	146
50	Up to 600	35	32	70	27	52	20	13	40	12	17	58	11	47.3	61	M8 x 1.25	7	18	11	M18 x 1.5	19	30	3/8	17	90	2.5	25	159
63	Up to 600	35	32	85	27	64	20	15.5	40	10	17	58	11	54.8	68.5	M10 x 1.25	7	18	14	M18 x 1.5	19	31	3/8	17	98	4	25	170
80	Up to 750	40	37	102	32	78	25	18.5	52	14	21	71	13	65.8	80.5	M12 x 1.75	11	22	17	M22 x 1.5	23	37	1/2	21	116	4	40	204
100	Up to 750	40	37	116	41	92	30	20	52	14	21	72	16	72.8	87.5	M12 x 1.75	11	26	17	M26 x 1.5	23	40	1/2	21	126	4	40	215

The dimensions for each mounting type and the dimensions of accessories (options) are the same as the standard double acting single rod model. Refer to pages 476 to 485.