

HEX NUT w/Conical Spring Washer

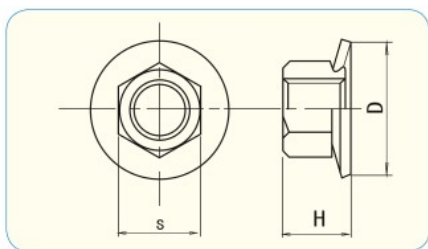

● **Material · plating**

Steel / Zinc 3Cr. Plated
Steel / Zinc Black 3Cr. Plated

| | Box q'ty | SIZE | | |
|-----|----------|------|------|----|
| | | s | H | D |
| M3 | 5000 | 5.5 | 3.3 | 7 |
| M4 | 2500 | 7 | 4.3 | 10 |
| M5 | 1500 | 8 | 5.5 | 12 |
| M6 | 700 | 10 | 6.7 | 14 |
| M8 | 400 | 13 | 8.8 | 18 |
| M10 | 200 | 17 | 10.7 | 22 |
| M12 | 100 | 19 | | 25 |

● **Material**

Stainless Steel A2

| | Box q'ty | SIZE | | |
|-----|----------|------|------|----|
| | | s | H | D |
| M4 | 2000 | 7 | 4.3 | 10 |
| M5 | 1000 | 8 | 5.5 | 12 |
| M6 | 700 | 10 | 6.7 | 14 |
| M8 | 300 | 13 | 8.8 | 18 |
| M10 | 150 | 17 | 10.7 | 22 |

HEX NUT w/Toothed Lock Washer

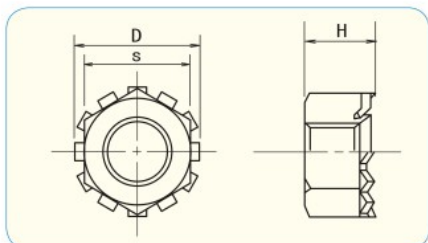

● **Material · plating**
Steel / Zinc 3Cr. Plated



| | Box q'ty | SIZE | | |
|----|----------|------|-----|------|
| | | s | H | D |
| M3 | 6000 | 5.5 | 3.2 | 6.5 |
| M4 | 2500 | 7 | 4 | 8.2 |
| M5 | 2000 | 8 | 5 | 9.5 |
| M6 | 1000 | 10 | 6.2 | 11.5 |
| M8 | 500 | 12 | | 15 |