

■ Connection : Thread⇔Tube

**PJNC** Elbow

RoHS compliant

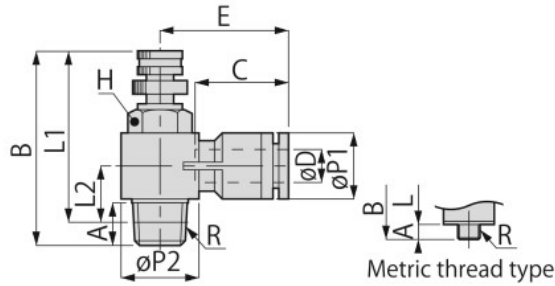

Chart P.513 CAD 2D & 3D

Unit : mm

| Model code   | Tube O.D.<br>øD | R      | A    | B    |      | L1   |      | L2   | øP1  | øP2  | Tube end<br>C | E    | Hex.<br>H | Weight<br>(g) | CAD<br>File name |          |
|--------------|-----------------|--------|------|------|------|------|------|------|------|------|---------------|------|-----------|---------------|------------------|----------|
|              |                 |        |      | max. | min. | max. | min. |      |      |      |               |      |           |               |                  |          |
| PJNC4-M5④⑥   | 4               | M5×0.8 | 3    | 29.7 | 27   | 26.7 | 24   | 7    | 9.9  | 9.8  | 15            | 20   | 8         | 7             | PJNC4-M5         |          |
| PJNC4-01④⑤⑥  |                 | R1/8   | 8    | 41.1 | 34.9 | 37.1 | 30.9 | 10.5 | 10   | 14.4 |               | 21.5 | 12        | 18            | PJNC4-01         |          |
| PJNC6-M5④⑥   | 6               | M5×0.8 | 3    | 29.7 | 27   | 26.7 | 24   | 8.2  | 12.4 | 9.8  | 17.1          | 24.1 | 8         | 8             | PJNC6-M5         |          |
| PJNC6-01④⑤⑥  |                 | R1/8   | 8    | 41.1 | 34.9 | 37.1 | 30.9 | 10.9 |      | 14.4 |               | 23.6 | 12        | 19            | PJNC6-01         |          |
| PJNC6-02④⑤⑥  |                 | R1/4   | 11.1 | 48.5 | 41.6 | 42.5 | 35.6 | 12.2 |      | 18.4 |               | 25.6 | 16        | 38            | PJNC6-02         |          |
| PJNC6-03④⑤⑥  |                 | R3/8   | 13.2 | 54.8 | 46.8 | 48.4 | 40.4 | 15.4 |      | 14.5 |               | 22   | 29.1      | 21            | 67               | PJNC6-03 |
| PJNC8-01④⑤⑥  | 8               | R1/8   | 8    | 41.4 | 34.9 | 37.1 | 30.9 | 11.9 | 14.4 | 14.4 | 18.1          | 26.9 | 12        | 22            | PJNC8-01         |          |
| PJNC8-02④⑤⑥  |                 | R1/4   | 11.1 | 48.5 | 41.6 | 42.5 | 35.6 | 13.2 |      | 18.4 |               | 28.4 | 16        | 41            | PJNC8-02         |          |
| PJNC8-03④⑤⑥  |                 | R3/8   | 13.2 | 54.8 | 46.8 | 48.4 | 40.4 | 15.4 |      | 14.5 |               | 22   | 28.9      | 21            | 69               | PJNC8-03 |
| PJNC8-04④⑤⑥  |                 | R1/2   | 16   | 59.6 | 52.2 | 51.4 | 44.1 | 18   |      | 14.4 |               | 28   | 31        | 27            | 103              | PJNC8-04 |
| PJNC10-02④⑤⑥ | 10              | R1/4   | 11.1 | 48.5 | 41.6 | 42.5 | 35.6 | 14.8 | 17.6 | 18.4 | 20.4          | 31.1 | 16        | 44            | PJNC10-02        |          |
| PJNC10-03④⑤⑥ |                 | R3/8   | 13.2 | 54.8 | 46.8 | 48.4 | 40.4 | 16.7 |      | 22   |               | 31.4 | 21        | 71            | PJNC10-03        |          |
| PJNC10-04④⑤⑥ |                 | R1/2   | 16   | 59.6 | 52.2 | 51.4 | 44.1 | 18   |      | 28   |               | 33.8 | 27        | 106           | PJNC10-04        |          |
| PJNC12-03④⑤⑥ | 12              | R3/8   | 13.2 | 54.8 | 46.8 | 48.4 | 40.4 | 18.4 | 21   | 22   | 23.6          | 37.1 | 21        | 74            | PJNC12-03        |          |
| PJNC12-04④⑤⑥ |                 | R1/2   | 16   | 59.6 | 52.2 | 51.4 | 44.1 | 19.7 |      | 28   |               | 36.6 | 27        | 109           | PJNC12-04        |          |

- ※1. ① and ② are reference values for height dimensions after tightening taper thread.
- ※2. ④ in Model code / Replaced with -F(FKM), or -HN(NHBR) for Seal rubber material change.
- ※3. ⑤ in Model code / Replaced with -S for Sealock, or -TP for Seal tape on thread.
- ※4. ⑥ in Model code / Replaced with -C for Clean-room package.

■ Connection : Tube⇔Tube

**PJNMU** Small union straight

RoHS compliant

Renewal

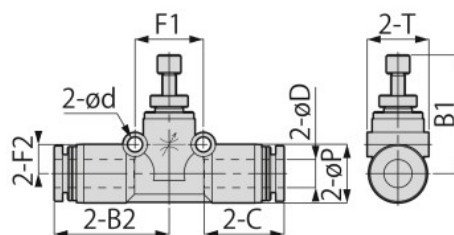

Chart P.513 CAD 2D & 3D

Unit : mm

| Model code | Tube O.D.<br>øD | B1   |      | B2   | øP   | T    | Tube end<br>C | ød  | F1   | F2   | Weight<br>(g) | CAD<br>File name |
|------------|-----------------|------|------|------|------|------|---------------|-----|------|------|---------------|------------------|
|            |                 | max. | min. |      |      |      |               |     |      |      |               |                  |
| PJNMU4④⑥   | 4               | 20.6 | 18.1 | 21.1 | 10   | 10.5 | 15            | 3.2 | 12.7 | 4.8  | 7.9           | PJNMU4_          |
| PJNMU6④⑥   | 6               | 25.3 | 21.5 | 24.6 | 12.5 | 13.1 | 17.1          | 3.2 | 14.8 | 6.2  | 13            | PJNMU6_          |
| PJNMU8④⑥   | 8               | 28.4 | 24.6 | 28   | 14.8 | 15.4 | 18.1          | 3.2 | 18.2 | 7.2  | 23            | PJNMU8_          |
| PJNMU10④⑥  | 10              | 32.9 | 28.9 | 32   | 18.2 | 19.7 | 20.4          | 4.2 | 22.2 | 8.7  | 41            | PJNMU10_         |
| PJNMU12④⑥  | 12              | 35.4 | 31.5 | 37.1 | 21.2 | 22.7 | 23.6          | 4.2 | 25.7 | 10.2 | 58            | PJNMU12_         |
| PJNMU1/4④⑥ | 1/4             | 25.3 | 21.5 | 24.6 | 12.5 | 13.1 | 17.1          | 3.2 | 14.8 | 6.2  | 13            | PJNMU1_4_        |
| PJNMU3/8④⑥ | 3/8             | 32.9 | 28.9 | 32   | 18.2 | 19.7 | 20.4          | 4.2 | 22.2 | 8.7  | 42            | PJNMU3_8_        |
| PJNMU1/2④⑥ | 1/2             | 35.4 | 31.5 | 37.4 | 21.2 | 22.7 | 23.9          | 4.2 | 25.7 | 10.2 | 57            | PJNMU1_2_        |

- ※1. ④ in Model code / Replaced with -F(FKM), or -HN(NHBR) for Seal rubber material change.
- ※2. ⑥ in Model code / Replaced with -C for Clean-room package.