

FITTING **PPX-SUS** Branch Y Thread material : SUS304

RoHS compliant

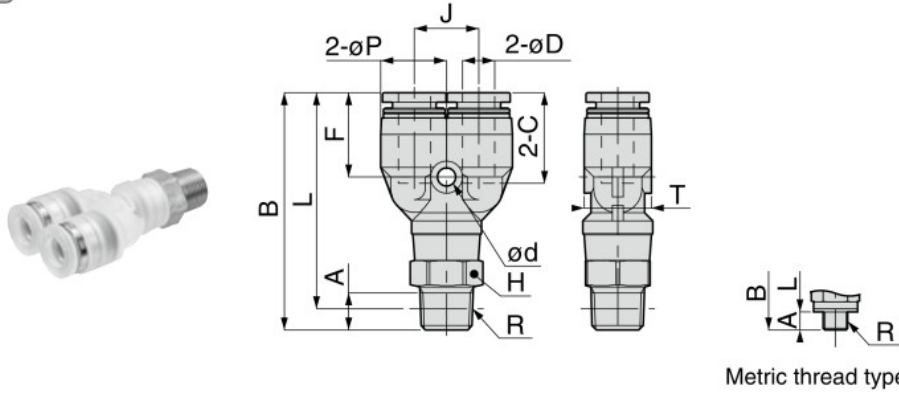

Unit : mm

Model code	Tube O.D. øD	R	A	B	L	øP	Tube end C	J	ød	F	T	Hex. H	Weight (g)	Effective area (mm ²)	CAD file name	
PPX4-M5SUS ^{⑤⑥}	4	M5×0.8	3	37.7	34.7	10	15	11	3.4	14.2	10	10	9.5	1.5	PPX4-M5SUS	
PPX4-01SUS ^{⑤⑥⑦}		R1/8	8	40.7	36.7								12.5	4.2	PPX4-01SUS	
PPX4-02SUS ^{⑤⑥⑦}		R1/4	11	43.7	37.7								14	20.5	PPX4-02SUS	
PPX6-M5SUS ^{⑤⑥}	6	M5×0.8	3	41.5	38.5	12.5	17.1	12	3.4	15.9	12.5	12	14	1.5	PPX6-M5SUS	
PPX6-01SUS ^{⑤⑥⑦}		R1/8	8	44.5	40.5								15.5	PPX6-01SUS		
PPX6-02SUS ^{⑤⑥⑦}		R1/4	11	47.5	41.5								14	23	10	PPX6-02SUS
PPX6-03SUS ^{⑤⑥⑦}		R3/8	12	49.3	43								17	21	PPX6-03SUS	
PPX8-01SUS ^{⑤⑥⑦}	8	R1/8	8	48.7	44.7	14.5	18.1	14	3.4	17.2	14.5	14	20.5	16.5	PPX8-01SUS	
PPX8-02SUS ^{⑤⑥⑦}		R1/4	11	51.7	45.7								25.5		PPX8-02SUS	
PPX8-03SUS ^{⑤⑥⑦}		R3/8	12	53.5	47.2								17		24.5	PPX8-03SUS
PPX10-02SUS ^{⑤⑥⑦}	10	R1/4	11	58.5	52.5	18	20.9	18	4.5	19.7	18	17	38	30	PPX10-02SUS	
PPX10-03SUS ^{⑤⑥⑦}		R3/8	12	59.5	53.2								45.5		PPX10-03SUS	
PPX12-03SUS ^{⑤⑥⑦}	12	R3/8	12	64.7	58.4	21	23.6	20	4.2	22.4	21	21	56.5	37	PPX12-03SUS	
PPX12-04SUS ^{⑤⑥⑦}		R1/2	15	67.7	59.5								71		PPX12-04SUS	

- ※ 1. "L" is a reference value for height dimension after tightening taper thread.
- ※ 2. ⑤ in Model code / Replaced with "F" (FKM), or "N" (NBR) for Seal rubber material change (No code: EPDM)
- ※ 3. ⑥ in Model code / Replaced with "S" for Sealock, or "TP" for Seal tape on thread.
- ※ 4. ⑦ in Model code / Replaced with "C" for Clean-room package