

### 20 series Plug

#### CPP20 Straight Tube Plug

CAD

RoHS compliant

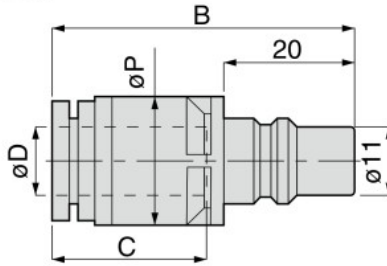

Unit : mm

Model code	Tube O.D. øD	B	øP	Tube end C	Weight (g)	Effective area (mm <sup>2</sup> )	CAD file name
CPP20-6□	6	38.8	16	17	7	12.5	TFLC-005
CPP20-8□	8	38.7		18.1		23.3	
CPP20-10□	10	45.2	20	20.2	13	33.8	
CPP20-12□	12	45.4		23.4	14	33.1	
CPP20-6S□	6	45.5	16	17.6	9	10.1	
CPP20-8S□	8	45.4		18.7		18	
CPP20-10S□	10	55.2	21	20.8	18	26	
CPP20-12S□	12	55.4		24	21	26.4	
CPP20-6C□	6	45.5	16	17.6	9	10.1	
CPP20-8C□	8	45.4		18.7		18	
CPP20-10C□	10	55.2	21	20.8	18	26	
CPP20-12C□	12	55.4		24	21	26.4	

#### CPP20 Elbow Tube Plug

CAD

RoHS compliant

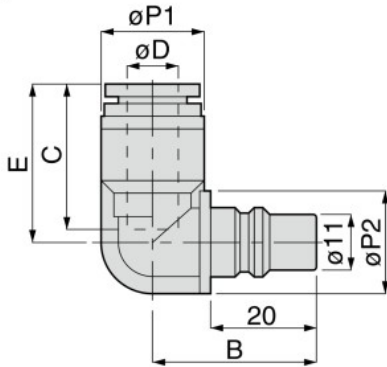

Unit : mm

Model code	Tube O.D. øD	B	øP1	øP2	Tube end C	E	Weight (g)	Effective area (mm <sup>2</sup> )	CAD file name
CPP20L-6□	6	28	14.5	16	17	23.8	8	10.7	TFLC-004
CPP20L-8□	8	28	14.5	16	18.1	23.7	8	17.5	
CPP20L-10□	10	31	21	18	20.2	29.7	15	26.3	
CPP20L-12□	12	31	21	18	23.4	29.9	16	29	