

Connector

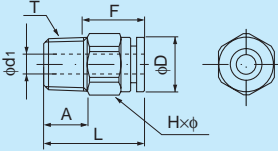

●Millimeter size type

Product number	Applicable tube outer diameter (mm)	T Thread size (R)	L (mm)	A (mm)	F Tube insertion length (mm)	H×φ Width across flat (mm)	D (mm)	d <sub>1</sub> (mm)	Effective cross-sectional area (mm <sup>2</sup> )	Weight (g)
EC4-R1/8-C1	4	R1/8	21.9	9.0	14	12.0×13.0	9.7	2.5	4.0	2.0
EC4-R1/4-C1	4	R1/4	24.9	12.0	14	14.0×15.4	9.7	2.5	4.0	2.0
EC6-R1/8-C1	6	R1/8	23.6	9.0	15	14.0×15.4	12.5	4.0	10.5	2.0
EC6-R1/4-C1	6	R1/4	26.6	12.0	15	14.0×15.4	12.5	4.0	10.5	3.0
EC8-R1/8-C1	8	R1/8	28.6	9.0	16	17.0×18.5	14.5	6.0	20.0	4.0
EC8-R1/4-C1	8	R1/4	27.6	12.0	16	17.0×18.5	14.5	6.0	25.0	4.0
EC10-R1/4-C1	10	R1/4	32.4	12.0	19	19.0×21.0	17.5	8.0	40.0	7.0
EC10-R3/8-C1	10	R3/8	33.2	14.0	19	19.0×21.0	17.5	8.0	40.0	7.0
EC10-R1/2-C1	10	R1/2	35.4	16.0	19	22.0×24.5	17.5	8.0	—	—
EC12-R3/8-C1	12	R3/8	33.4	14.0	20	22.0×24.5	21.0	10.0	50.0	9.0
EC12-R1/2-C1	12	R1/2	35.4	16.0	20	22.0×24.5	21.0	10.0	50.0	11.0

EC6-N1/8-C1	6	NPT1/8	23.6	9.0	15	14.0×15.4	12.5	4.0	10.5	2.0
EC6-N1/4-C1	6	NPT1/4	26.6	12.0	15	14.0×15.4	12.5	4.0	10.5	3.0
EC10-N1/4-C1	10	NPT1/4	32.4	12.0	19	19.0×21.0	17.5	8.0	40.0	7.0

●Inch size type

Product number	Applicable tube outer diameter (inch)	T Thread size (R)	L (mm)	A (mm)	F Tube insertion length (mm)	H×φ Width across flat (mm)	D (mm)	d <sub>1</sub> (mm)	Effective cross-sectional area (mm <sup>2</sup> )	Weight (g)
EC1/4-R1/8-C1	1/4	R1/8	24.6	9.0	16	14.0×15.4	12.5	4.0	12.0	2.0
EC1/4-R1/4-C1	1/4	R1/4	27.6	12.0	16	14.0×15.4	12.5	4.0	12.0	3.0
EC3/8-R1/4-C1	3/8	R1/4	33.2	12.0	20	19.0×21.0	17.5	8.0	35.0	7.0
EC3/8-R3/8-C1	3/8	R3/8	34.0	14.0	20	19.0×21.0	17.5	8.0	35.0	7.0
EC1/2-R3/8-C1	1/2	R3/8	26.1	14.0	23	22.0×24.5	21.0	10.0	66.5	9.0
EC1/2-R1/2-C1	1/2	R1/2	29.1	16.0	23	22.0×24.5	21.0	10.0	66.5	10.0

Through connector A tube can be inserted completely through the connector.

●Millimeter size type

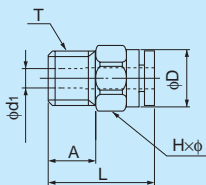

Product number	Applicable tube outer diameter (mm)	T Thread size (R)	L (mm)	A (mm)	H×φ Width across flat (mm)	D (mm)	d <sub>1</sub> (mm)	Weight (g)
ETC4-R1/8-C1	4	R1/8	21.9	9.0	12.0×13.0	9.7	4.2	2.0
ETC4-R1/4-C1	4	R1/4	24.9	12.0	14.0×15.4	9.7	4.2	2.0
ETC6-R1/4-C1	6	R1/4	26.6	12.0	14.0×15.4	12.5	6.6	3.0
ETC8-R1/4-C1	8	R1/4	27.6	12.0	17.0×18.5	14.5	8.2	4.0
ETC10-R3/8-C1	10	R3/8	33.2	14.0	19.0×21.0	17.5	10.2	7.0
ETC12-R1/2-C1	12	R1/2	35.4	16.0	22.0×24.5	21.0	12.3	10.0

Tube

Clean tube

Processed tube

PushOne fitting

QuickSeal fitting

Clean fitting/ Chemifit

Bamboo-shoot fitting

Control switch/ Detachable series

Jig/Tool/ Accessory

Technical information

Reference