

2-Flute Taper Ball End Mill

CBN
Cubic Boron
Nitride

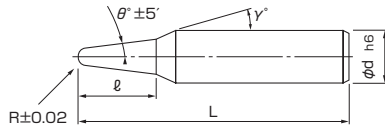

- この規格・サイズは、特定商社在庫となります。
詳しくはお問い合わせ下さい。
- Semi-standard item, please inquire for price and delivery.



被削材 Work Material									
炭素鋼 Carbon Steels	合金鋼・工具鋼 Alloy Steels・Tool Steels	プリハードン鋼・調質鋼 Prehardened Steels	焼き入れ鋼 Hardened Steels		ステンレス鋼 Stainless Steels	チタン合金 Titanium Alloy	アルミ合金 Aluminum	銅合金 Copper	樹脂 Plastic
○	○	○	~ 55HRC	55HRC ~	○		○	○	○

単位 [寸法 : mm]
Unit [size : mm]

コードNo. Code No.	内径半径 Radius	(θ)片角 Taper Angle	(L)刃長 Length of Cut	(d)大径径 Dia. at Large End	(γ)首角 Neck Taper Angle	(d)シャンク径 Shank Dia.	(L)全長 Overall Length	標準価格 Retail Price
01-00352-00501	R0.5	30°	10	1.17	9°	4	50	(17,000)
01-00352-00502		1°	10	1.33	9°	4	50	(17,000)
01-00352-00503		1°30'	10	1.50	9°	4	50	(17,000)
01-00352-00504		2°	10	1.66	9°	4	50	(17,000)
01-00352-00505		3°	10	2.00	9°	4	50	(17,000)
01-00352-00506		4°	10	2.33	9°	4	50	(17,000)
01-00352-00507		5°	10	2.67	9°	4	50	(17,000)
01-00352-00508		7°	10	3.34	7°	4	50	(17,000)
01-00352-00509		10°	10	4.37	-	4	50	(20,000)
01-00352-00751	R0.75	30°	10	1.66	9°	4	50	(16,000)
01-00352-00752		1°	10	1.82	9°	4	50	(16,000)
01-00352-00753		1°30'	10	1.99	9°	4	50	(16,000)
01-00352-00754		2°	10	2.15	9°	4	50	(16,000)
01-00352-00755		3°	10	2.47	9°	4	50	(16,000)
01-00352-00756		4°	10	2.80	9°	4	50	(16,000)
01-00352-00757		5°	10	3.12	9°	4	50	(16,000)
01-00352-00758		7°	10	3.78	7°	4	50	(16,000)
01-00352-00759		10°	10	4.79	-	4	50	(18,200)
01-00352-01001	R1	30°	13	2.21	9°	4	55	(13,500)
01-00352-01002		1°	13	2.42	9°	4	55	(13,500)
01-00352-01003		1°30'	13	2.63	9°	4	55	(13,500)
01-00352-01004		2°	13	2.84	9°	4	55	(13,500)
01-00352-01005		3°	13	3.26	9°	4	55	(13,500)
01-00352-01006		4°	13	3.68	4°	4	55	(17,000)
01-00352-01007		5°	13	4.11	-	4	55	(17,000)
01-00352-01008		7°	13	4.96	-	4	55	(17,000)
01-00352-01009		10°	13	6.26	-	6	55	(21,100)
01-00352-01251	R1.25	30°	15	2.74	9°	4	55	(16,400)
01-00352-01252		1°	15	2.98	9°	4	55	(16,400)
01-00352-01253		1°30'	15	3.22	9°	4	55	(16,400)
01-00352-01254		2°	15	3.46	9°	4	55	(16,400)
01-00352-01255		3°	15	3.94	-	4	55	(16,400)
01-00352-01256		4°	15	4.43	-	4	55	(16,400)
01-00352-01257		5°	15	4.92	-	4	55	(17,200)
01-00352-01258		7°	15	5.90	-	6	55	(17,200)
01-00352-01259		10°	15	7.39	-	6	55	(22,900)

コードNo. Code No.	内径半径 Radius	(θ)片角 Taper Angle	(L)刃長 Length of Cut	(d)大径径 Dia. at Large End	(γ)首角 Neck Taper Angle	(d)シャンク径 Shank Dia.	(L)全長 Overall Length	標準価格 Retail Price
01-00352-01501	R1.5	30°	20	3.32	9°	4	60	(16,000)
01-00352-01502		1°	20	3.65	9°	4	60	(16,000)
01-00352-01503		1°30'	20	3.97	-	4	60	(16,000)
01-00352-01504		2°	20	4.29	-	4	60	(16,000)
01-00352-01505		3°	20	4.94	-	4	60	(16,000)
01-00352-01506		4°	20	5.60	4°	6	60	(17,000)
01-00352-01507		5°	20	6.25	-	6	65	(19,000)
01-00352-01508		7°	20	7.57	7°	8	65	(19,000)
01-00352-01509		10°	20	9.57	-	10	70	(22,900)
01-00352-02001	R2	30°	25	4.40	-	4	60	(16,800)
01-00352-02002		1°	25	4.80	-	4	60	(16,800)
01-00352-02003		1°30'	25	5.21	9°	6	60	(16,800)
01-00352-02004		2°	25	5.61	2°	6	60	(16,800)
01-00352-02005		3°	25	6.42	-	6	60	(17,700)
01-00352-02006		4°	25	7.23	4°	8	65	(20,000)
01-00352-02007		5°	25	8.04	-	8	65	(22,200)
01-00352-02008		7°	25	9.68	7°	10	70	(28,500)
01-00352-02009		10°	25	12.17	-	12	70	(38,300)
01-00352-02501	R2.5	30°	30	5.48	9°	6	65	(18,000)
01-00352-02502		1°	30	5.96	1°	6	65	(18,000)
01-00352-02503		1°30'	30	6.44	-	6	65	(19,000)
01-00352-02504		2°	30	6.92	-	6	65	(19,000)
01-00352-02505		3°	30	7.89	3°	8	70	(22,900)
01-00352-02506		4°	30	8.86	-	8	75	(28,500)
01-00352-02507		5°	30	9.83	5°	10	80	(32,400)
01-00352-02508		7°	30	11.79	7°	12	85	(38,200)
01-00352-02509		10°	30	14.78	10°	16	90	(52,500)
01-00352-03001	R3	30°	35	6.56	-	6	70	(22,900)
01-00352-03002		1°	35	7.12	-	6	70	(22,900)
01-00352-03003		1°30'	35	7.68	-	6	70	(22,900)
01-00352-03004		2°	35	8.24	-	8	80	(25,000)
01-00352-03005		3°	35	9.36	-	8	85	(32,600)
01-00352-03006		4°	35	10.49	-	10	90	(36,400)
01-00352-03007		5°	35	11.62	5°	12	90	(49,700)
01-00352-03008		7°	35	13.90	-	12	95	(78,600)
01-00352-03009		10°	35	17.38	-	16	100	(113,000)

オーダー方法

NTB-2 ボール半径寸法(R)×片角(θ)を指示して下さい。
When you order, indicate NTB-2 (R)×(θ).

※(γ)は参考値です。

※(γ) is reference value.