

NJW Series Shell Size 16

NJW

16

[Power receiving side] < Pin (male) contact used >

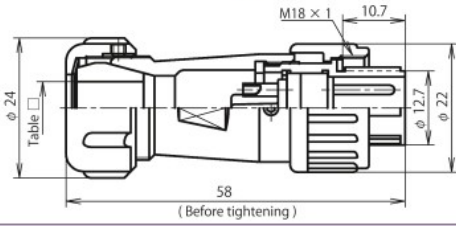

NJW-16 ■ -PM □

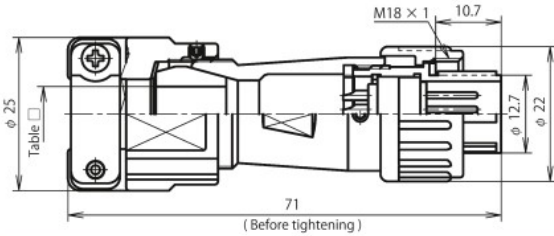

NJW-16 ■ -PMK □

Cap · L za pp.90-91

For the plug and adapter, be sure to select □ (cable packing symbol).

Table □

In order to secure the intended waterproof function, a cable to be used for the plug/adapter should have an appropriate specification and structure.

Shell size	Symbol □	Outer diameter of cable used	Normal products		Safety standard	
			Standard	K Type	Standard	K Type
16	5	φ 4.0 to φ 4.8	●	—	—	—
	7	φ 5.7 to φ 6.8	●	●	—	—
	8	φ 6.9 to φ 7.9	●	●	—	—
	9	φ 8.0 to φ 9.4	●	●	●	—
	11	φ 9.5 to φ 11.0	●	●	●	—

G Type

Plug

Coupled

Receptacle

Adapter

[Power supply side] < Socket (female) contact used >

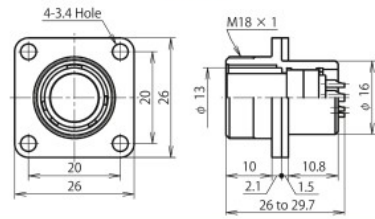

NJW-16 ■ -RF

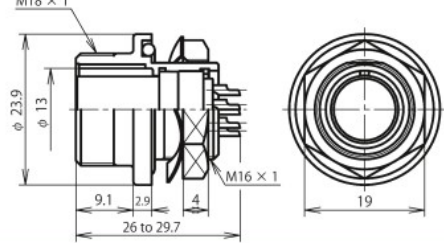

NJW-16 ■ -RBF

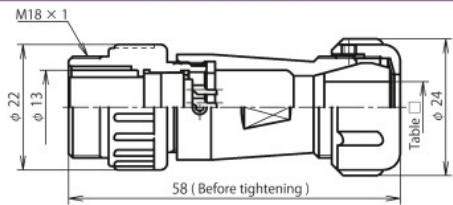

NJW-16 ■ -AdF □

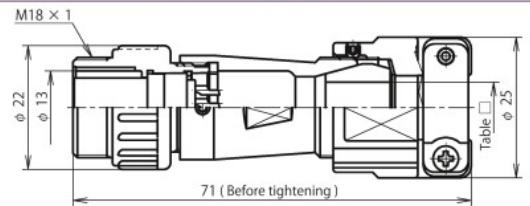

NJW-16 ■ -AdFK □

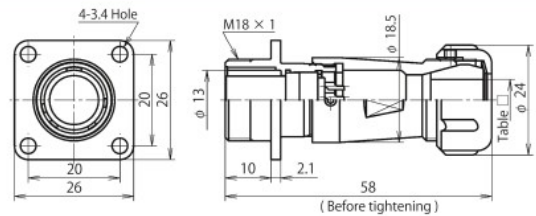

NJW-16 ■ -Ad(F)F □

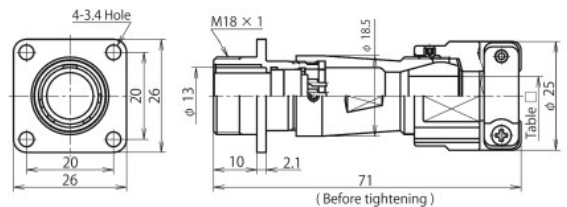

NJW-16 ■ -Ad(F)FK □

■ indicates the number of contacts. Contact arrangement p.78.

The conductor cross sectional area is less than the following value. However, for safety standard compliant products, use a cable having a value shown on p.128.

Shell size	Number of Contacts	3	5	8
16	Safety standard (Note-1)	UL·CSA		—
	Rating (Allowable current for signals)	125V 10A	125V 5A	[3A]
	Withstand voltage (V r.m.s.)	1,500	1,000	500
	Wire size (mm ²)	1.25	0.5	0.3
	Remarks	—		For signals

[] : Gold plating contact

Note-1 : Specified separately. *Specified as a set of UL and CSA*. For safety standards, see p.128.