

## Product models & dimensions

### Plug

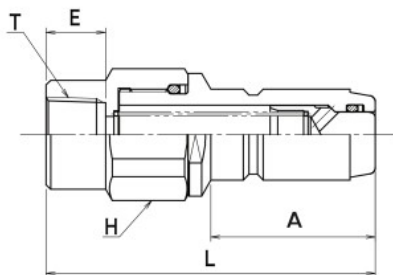

Model	L (MM)	A (MM)	E (MM)	T	H (MM)	W (g)
N350 - 2P	72	36	13	Rc 1/4	HEX 27	168
N350 - 3P	72	36	13	Rc 3/8	HEX 27	176
N350 - 4P	82.5	40.5	18	Rc 1/2	HEX 32	271
N350 - 6P	90	44.5	18	Rc 3/4	HEX 41	483
N350 - 8P	119	57	22	Rc 1	HEX 50	1038

### Socket

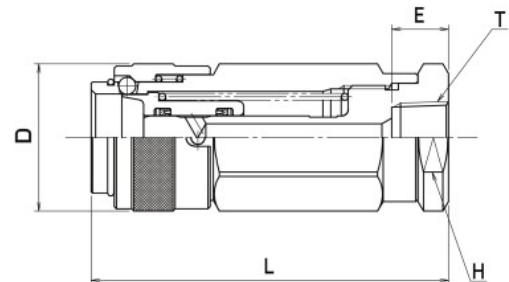

Model	L (MM)	D (MM)	E (MM)	T	H (MM)	W (g)
N350 - 2S	82	34	13	Rc 1/4	FW 30	360
N350 - 3S	82	34	13	Rc 3/8	FW 30	369
N350 - 4S	93.5	41	16	Rc 1/2	FW 36	559
N350 - 6S	105.5	49	18	Rc 3/4	FW 46	986
N350 - 8S	129	63	22	Rc 1	FW 55	1753



Order size	Model	Working pressure MPa (kgf/cm <sup>2</sup> )	Pressure resistance MPa (kgf/cm <sup>2</sup> )	Total length (when connected) L (mm)
1/4	N350 - 2SP	34.3 (350)	51.5 (525)	69.2
3/8	N350 - 3SP			78.4
1/2	N350 - 4SP			89.1
3/4	N350 - 6SP			95.1
1	N350 - 8SP			119.3

### Ordering information

**N350 - 2 S**

① ②

① Size

2	1/4
3	3/8
4	1/2
6	3/4
8	1

② Type

S	Socket
P	Plug