

Product models & dimensions

Plug

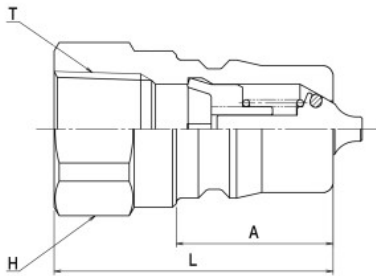

Socket

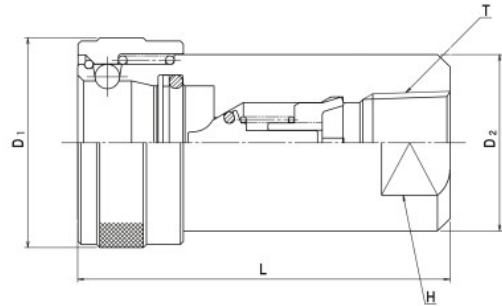

Model	L (MM)	A (MM)	T	H (MM)	W (g)
PH - 270	34.5	17.5	Rc 1/4	HEX 19	42
PH - 370	40	22.5	Rc 3/8	HEX 23	67
PH - 470	44	27.5	Rc 1/2	HEX 29	126
PH - 670	50	27.5	Rc 3/4	HEX 32	144
PH - 870	61	36	Rc 1	HEX 41	319
PH - 1070	80.1	58	Rc 1 1/4	FW 58	902

Model	L (MM)	D1 (MM)	D2 (MM)	T	H (MM)	W (g)
SH - 270	51.6	28	24	Rc 1/4	FW 19	141
SH - 370	60	34	28.6	Rc 3/8	FW 23	226
SH - 470	72.2	43	38.5	Rc 1/2	FW 35	482
SH - 670	72.2	43	38.5	Rc 3/4	FW 35	457
SH - 870	93.2	58	52.2	Rc 1	FW 46	1040
SH - 1070	138.1	86.8	64	Rc 1 1/4	FW 58	2610

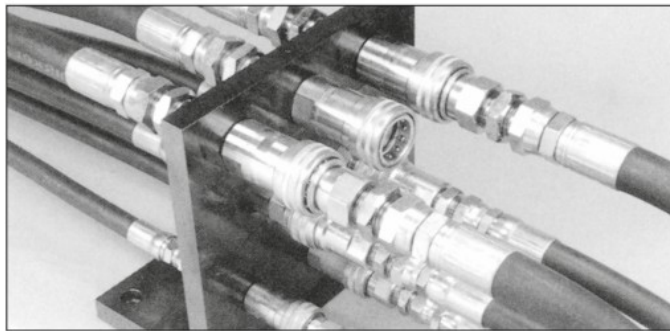

Order size	Model	Working pressure MPa (kgf/cm ²)	Pressure resistance MPa (kgf/cm ²)	Total length (when connected) L (mm)
1/4	SPH - 270	20.6 (210)	30.9 (315)	69.2
3/8	SPH - 370			78.4
1/2	SPH - 470			89.1
3/4	SPH - 670			95.1
1	SPH - 870			119.3
1 1/4	SPH - 1070	17.6	26.4	161

Ordering information

S H 270 - N (-LT)

① ② ③ ④

① Type

S	Socket
P	Plug

② Size

270	1/4
370	3/8
470	1/2
670	3/4
870	1
1070	1 1/4

③ Seal material

N	Nitrile butadiene rubber
V	Fluorine rubber

④ Option

LT	With lock system for socket.
----	------------------------------