

MOHS-C

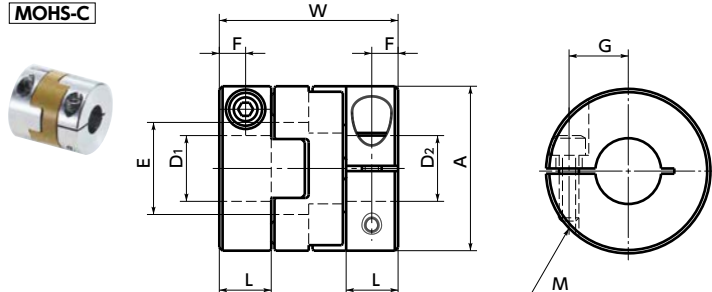

Dimensions

Unit : mm

Part Number	A	L	W	E	F	G	M	Screw Tightening Torque (N·m)
MOHS-19C	19	7	22.1	10	3.5	6.5	M2.5	0.5
MOHS-26C	25.4	8	27.2	14	4	9	M3	0.7
MOHS-32C	31.7	10	33.3	18	5	11	M4	1.2

Part Number	Standard Bore Diameter							
	D1 · D2	5	6	8	10	11	12	14
MOHS-19C	●	●	●					
MOHS-26C			●	●				
MOHS-32C			●	●	●	●	●	●

- All products are provided with hex socket head cap screw.
- Recommended dimensional allowances of applicable shaft diameter are h6 and h7.
- In case of mounting on D-cut shaft, be careful about the position of the D-cut surface of the shaft. → P.257

Additional Keyway at Shaft Hole → P.788

Cleanroom Wash & Packaging → P.792

Change to Stainless Steel Screw → P.790

Available / Add'l charge

Cleanroom washed and packed

Changed to the S.S. screw