

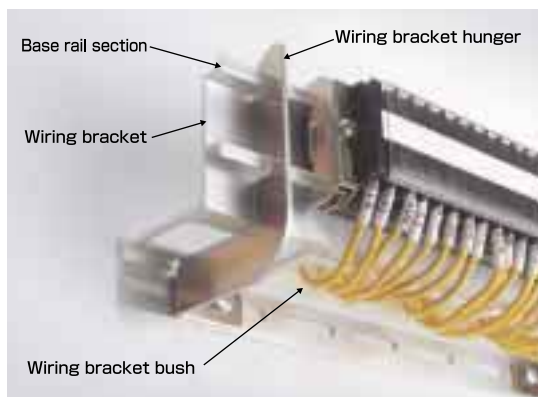

Wiring Bracket



Example of use

Features

- One-piece assembly of a base rail and a bracket with wire space.
- The front of the wire space accepts various control parts (e.g., terminal box), allowing space-saving wiring in a board.
- Integral design of base rail and wire space permits one-time installation into a board, reducing man hour.
- IN/OUT wiring is accomplished through wiring holes and openings.
- Wiring holes are chamfered.

How to Use

- Secure the bracket to the installation face with screws through the mounting holes.
- Install wires through wiring holes and openings.

Color

- Silver



Wiring bracket bush (KWB-B)/Optional

Part No.	H × W	Material	Quantity
KWB-B	39.8×23.8	66 nylon	300

UL Approved Resin Used UL94-V0

Part No.	W	H	Length	Material	Quantity
KWB-45	50	45	1,000	Aluminum	14
KWB-65	50	65			

(Unit: mm)

Cross Section

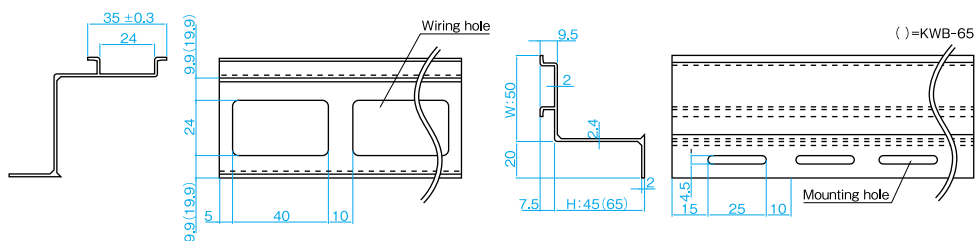

Wiring Bracket Hunger



Cross Section

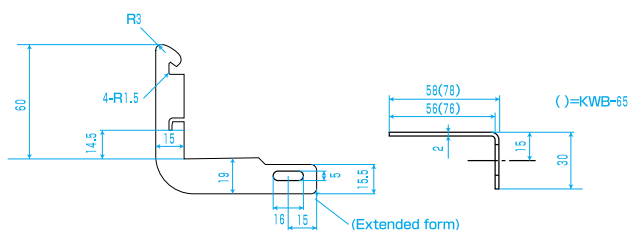

Part No.	Corresponding Part No.
KWB-H45	KWB-45
KWB-H65	KWB-65

Features

- Fitting to a wiring bracket improves shock resistance.
- Allows for upward and downward installation.
- The hangers can be fit even after wiring work is done.
- Wiring work can be done even after the hangers are fit.

How to Use

- Upward installation
- Downward installation

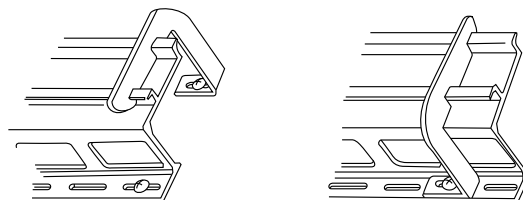

Quantity

- 50 sets (1 set: one piece for right and left each)

Notes for Use

- Downward installation may loosen the mounting screws due to vibrations from transportation etc. To prevent this, use spring washers etc.
- Do not use the product for applications other than the above.

Application

- Designed to support a wiring bracket

Surface Treatment

- Trivalent chromate treatment

Material

- Steel sheet