

DIMENSIONS and SPECIFICATIONS

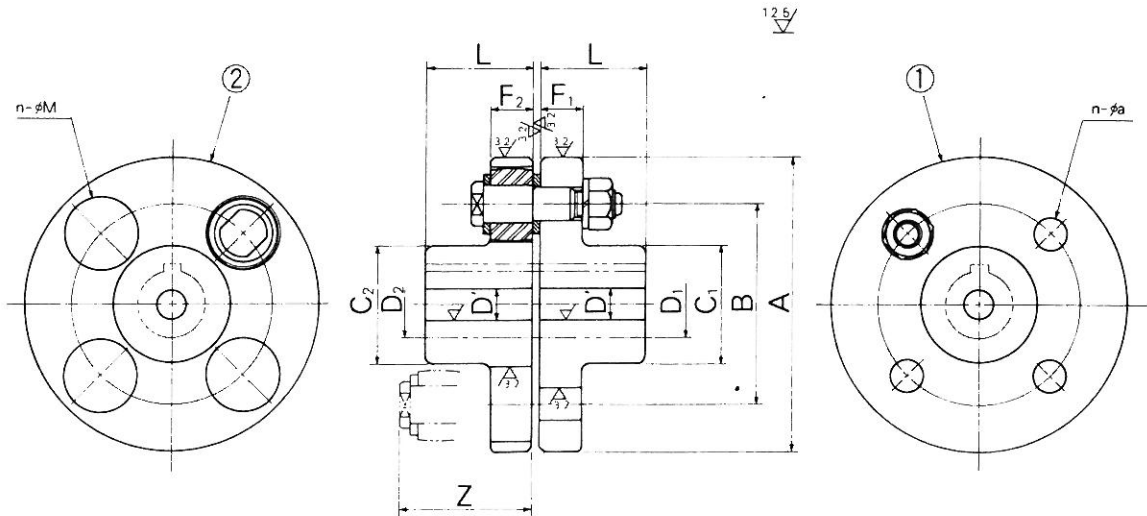

(Table A)

(mm)

| type number A | ④ Max. shaft dia | | ⑤ pilot bore D' | L | C | | F ₁ | F ₂ | n | a | M | ① t | Reference | | Transmit torque T (kgfm) | Max. rpm | | Bolt NO. |
|------------------|------------------|----------------|-----------------|---------|----------------|----------------|----------------|----------------|----|---|-----|------|---------------------------|--------------|--------------------------|-----------------|-------|----------|
| | D ₁ | D ₂ | | | C ₁ | C ₂ | | | | | | | Bolt remove clearance (z) | Weight (kg)② | | material | | |
| | | | | | | | | | | | | | | | | FC20 (standard) | S35C③ | |
| CL 90 | 20 | 11 | 28 | 35.5 | 14 | 14 | 4 | 8 | 19 | 3 | 50 | 1.5 | 0.4 | 4,000 | 6,000 | # 1 | | |
| CL 100 | 25 | 11 | 35.5 | 42.5 | 16 | 16 | 4 | 10 | 23 | 3 | 56 | 2.2 | 1 | 4,000 | 6,000 | # 2 | | |
| CL 112 | 28 | 13 | 40 | 50 | 16 | 16 | 4 | 10 | 23 | 3 | 56 | 2.9 | 1.6 | 4,000 | 6,000 | # 2 | | |
| CL 125 | 32 28 | 13 | 45 | 56 50 | 18 | 18 | 4 | 14 | 32 | 3 | 64 | 3.9 | 2.5 | 4,000 | 6,000 | # 3 | | |
| CL 140 | 38 35 | 13 | 50 | 71 63 | 18 | 18 | 6 | 14 | 32 | 3 | 64 | 5.4 | 5 | 4,000 | 6,000 | # 3 | | |
| CL 160 | 45 | 15 | 56 | 80 | 18 | 18 | 8 | 14 | 32 | 3 | 64 | 7.6 | 11.2 | 4,000 | 6,000 | # 3 | | |
| CL 180 | 50 | 15 | 63 | 90 | 18 | 18 | 8 | 14 | 32 | 3 | 64 | 10.3 | 16 | 3,500 | 5,250 | # 3 | | |
| CL 200 | 56 | 21 | 71 | 100 | 22.4 | 22.4 | 8 | 20 | 41 | 4 | 85 | 15.7 | 25 | 3,200 | 4,800 | # 4 | | |
| CL 224 | 63 | 21 | 80 | 112 | 22.4 | 22.4 | 8 | 20 | 41 | 4 | 85 | 20.7 | 40 | 2,850 | 4,300 | # 4 | | |
| CL 250 | 71 | 25 | 90 | 125 | 28 | 28 | 8 | 25 | 51 | 4 | 100 | 30 | 63 | 2,550 | 3,800 | # 5 | | |
| CL 280 | 80 | 34 | 100 | 140 | 28 | 40 | 8 | 28 | 57 | 4 | 116 | 42 | 100 | 2,300 | 3,450 | # 6 | | |
| CL 315 | 90 | 41 | 112 | 160 | 28 | 40 | 10 | 28 | 57 | 4 | 116 | 56 | 160 | 2,050 | 3,050 | # 6 | | |
| CL 355 | 100 | 60 | 125 | 180 | 35.5 | 56 | 8 | 35.5 | 72 | 5 | 150 | 86 | 250 | 1,800 | 2,700 | # 8 | | |
| CL 400 | 110 | 60 | 125 | 200 | 35.5 | 56 | 10 | 35.5 | 72 | 5 | 150 | 109 | 400 | 1,600 | 2,400 | # 8 | | |
| CL 450 | 125 | 65 | 140 | 224 | 35.5 | 56 | 12 | 35.5 | 72 | 5 | 150 | 144 | 630 | 1,400 | 2,150 | # 8 | | |
| CL 560 | 140 | 85 | 160 | 250 | 35.5 | 56 | 14 | 35.5 | 72 | 5 | 150 | 225 | 1,000 | 1,150 | 1,700 | # 8 | | |
| CL 630 | 160 | 95 | 180 | 280 | 35.5 | 56 | 18 | 35.5 | 72 | 5 | 150 | 298 | 1,600 | 1,000 | 1,500 | # 8 | | |

- Note:
- ① t ... Clearance when couplings assembled in the final position. The clearance value equals to thickness of washer using for connecting bolt/nut.
 - ② Weight for one set of couplings including connecting bolts and nuts.
 - ③ Cast-iron material (FC) is supplied for coupling body unless specified by customer. If carbon steel forgings (S35C) is required, specify clearly when ordering.
 - ④ For carbon steel forgings material, max. shaft diameter can be enlarged by approx. 6%.
 - ⑤ Rough bore machining is given when delivered to customer.