



Minimum tube length



Spring loaded shaft

# MDR Brushless DC Motor standard type PM500FE

Roller diameter  $\varnothing 50$

## Roller diameter $\varnothing 50$ PM500FE

- Roller diameter /  $\varnothing 50$
- Thickness / t1.4
- Voltage / 24V DC
- Tube material / STKM12
- Surface treatment / Trivalent chromate processing

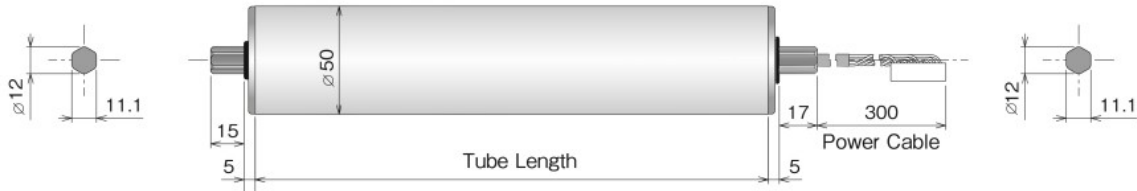

### Tube Length : PM500FE

	290mm		290mm $\leq$						
Tube Length (mm)	300	400	500	600	700	800	900	1000	
Weight (kg)	2.4	2.5	2.7	2.8	3.0	3.1	3.3	3.4	
Spring loaded shaft	<input type="checkbox"/>	<input type="checkbox"/>	<input type="checkbox"/>	<input type="checkbox"/>	<input type="checkbox"/>	<input type="checkbox"/>	<input type="checkbox"/>	<input type="checkbox"/>	

- Conveyor frame inside dimension and frame hole shape vary by the manufacturer.
- A gap of 2-5mm is required between the frame inside dimension and Power Moller.

### Product Designation :

PM500FE - 17 - 400 - D - 024 - **BR**

Power Moller model    Nominal Speed    Tube Length    Voltage    Options

- Motor type : FE
- Nominal Speed : 17,60,90
- Tube Length : Specify in mm.
- Voltage : D-024 (24VDC)
- Options : Each of the following optional specification may be selected.

### Mounting Bracket : No.MBB-081

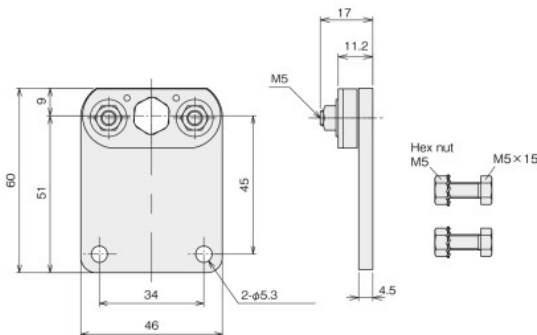

- \*Attach to the power cable side.
- Apply 6-10Nm torque for securing the Power Moller mounting shaft, and 3.5Nm for securing the bracket.

### Options : PM500FE

- Rubber Laggings - NR, UR, NB, CR**  
Natural rubber, Urethane, NBR, Neoprene
- BR Built-In Brake - BR** <sup>#1</sup>  
360mm    360mm $\leq$
- DR Drip Proof** <sup>#2</sup>  
300mm    300mm $\leq$
- WA Water Proof** <sup>#2</sup>  
310mm    310mm $\leq$
- VG Poly V-Belt Pulley**  
290mm    290mm $\leq$
- VP V-Belt Pulley**  
290mm    290mm $\leq$
- P2 Double Grooved Tube** <sup>#3</sup>  
340mm    340mm $\leq$

**JD**

### Both-end D-shaped shaft

- <sup>#1</sup> When holding type built-in brake is required, specify along with a driver card compatible with such brake specification.  
[Electric brake (without holding function) is equipped as a standard specification.]  
Nominal speed 90m/min rollers are not applicable.
- <sup>#2</sup> Manufacturability and tube length are different depending on the specification combination, contact our sales support.  
(A standard mounting bracket is No. MBD-081-D.)
- <sup>#3</sup> Up to 800mm can be produced.