

HPTBE

切削条件表

P347

テーパボールエンドミル Taper Ball End Mill

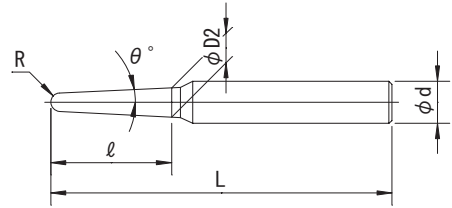

公差 (Tolerance)	R: ±0.02	θ: ±5'	d: h7
----------------	----------	--------	-------

右刃右ネジレ30° 刃数:2 粉末ハイス
Helix Angle-Right30° Number of Flute:2 Powder Metallurgy

寸法 R	片角 (θ) Taper Angle	刃長 (ℓ) Cut Length	大径 (ΦD2) Diameter at Large End	全長 (L) Overall Length	シャンク径 (Φd) Shank Dia.
0.5	30'	4	1.06	45	6
	1°	4	1.12	45	6
	1° 30'	4	1.18	45	6
	2°	4	1.25	45	6
	2° 30'	4	1.31	45	6
	3°	4	1.37	45	6
	4°	6	1.77	45	6
	5°	6	1.97	45	6
	7°	6	2.35	45	6
	10°	6	2.95	45	6
15°	6	3.98	45	6	
0.75	30'	8	1.63	50	6
	1°	8	1.75	50	6
	1° 30'	8	1.88	50	6
	2°	8	2.01	50	6
	2° 30'	8	2.13	50	6
	3°	8	2.26	50	6
	4°	10	2.8	65	6
	5°	10	3.12	65	6
	7°	10	3.78	65	6
	10°	10	4.78	65	6
15°	10	6.5	65	6	
1	30'	10	2.16	55	6
	1°	15	2.49	60	6
	1° 30'	15	2.73	60	6
	2°	20	3.33	65	6
	2° 30'	20	3.66	65	6
	3°	20	3.99	65	6
	4°	20	4.66	65	6
	5°	20	5.33	65	6
	7°	20	6.68	65	6
	10°	20	8.73	70	8
15°	20	12.25	70	12	
1.25	30'	25	2.91	80	6
	1°	25	3.33	80	6
	1° 30'	25	3.74	80	6
	2°	25	4.16	85	6
	2° 30'	25	4.57	85	6
	3°	25	4.98	85	6
	4°	25	5.83	85	6
	5°	25	6.67	85	6
	7°	25	8.35	90	8
	10°	25	10.91	95	10
15°	25	15.31	100	16	
1.5	30'	25	3.41	80	6
	1°	25	3.82	80	6

寸法 R	片角 (θ) Taper Angle	刃長 (ℓ) Cut Length	大径 (ΦD2) Diameter at Large End	全長 (L) Overall Length	シャンク径 (Φd) Shank Dia.
1.5	1° 30'	25	4.23	80	6
	2°	25	4.64	85	6
	2° 30'	25	5.05	85	6
	3°	25	5.47	85	6
	4°	25	6.29	85	6
	5°	25	7.12	90	8
	7°	25	8.79	95	10
	10°	25	11.33	100	12
	15°	25	15.69	100	16
	1.75	30'	30	3.99	90
1°		30	4.49	90	6
1° 30'		30	4.98	90	6
2°		30	5.48	95	6
2° 30'		30	5.97	95	6
3°		30	6.47	95	6
4°		30	7.46	95	8
5°		30	8.46	95	8
7°		30	10.46	100	10
10°		30	13.52	100	12
15°	30	18.76	100	20	
2	30'	30	4.49	90	6
	1°	30	4.98	90	6
	1° 30'	30	5.47	90	6
	2°	30	5.96	95	8
	2° 30'	30	6.45	95	8
	3°	30	6.94	95	8
	4°	30	7.93	95	8
	5°	30	8.91	100	10
	7°	30	10.9	105	12
	10°	30	13.94	110	16
15°	30	19.14	110	20	
2.25	30'	35	5.07	100	6
	1°	35	5.64	100	6
	1° 30'	35	6.21	100	6
	2°	35	6.79	110	8
	2° 30'	35	7.36	110	8
	3°	35	7.93	110	8
	4°	35	9.09	110	10
	5°	35	10.24	110	10
	7°	35	12.57	110	12
	10°	35	16.11	120	16
2.5	30'	35	5.57	100	6
	1°	35	6.14	100	6
	1° 30'	35	6.7	100	6
	2°	35	7.27	110	8
2° 30'	35	7.84	110	8	