

CKe galvanized iron pipe fitting

Unions (type F) (U)

Unions (type C-1)

Unit : mm

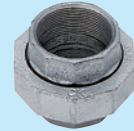
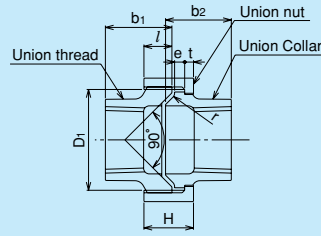
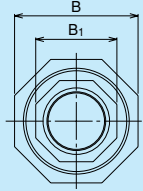
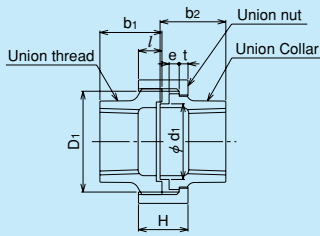

Fitting sizes	Union threads and union collars						Union nuts				D ₁ thread Nominal sizes D ₁	
	Thread lengths l	b ₁	Collar thickness e	b ₂	d ₁	Widths across flats, B ₁		Heights H	Thickness t	Widths across flats, B		
						Octagon	Decagon			Octagon		Decagon
1/4	7	17	2.5	18	16.5	19	—	13.5	2.5	31	—	M 26×1.5
3/8	8	19	3	20.5	20	23	—	16	3	37	—	M 31×2
1/2	9	21	3	21.5	24	27	—	17	3	42	—	M 35×2
3/4	9.5	24.5	3.5	26	30	33	—	18.5	3.5	49	—	M 42×2
1	10	27	4	29	38	41	—	20	4	59	—	M 51×2
1 1/4	11	30	4.5	32	46	—	50	22	4.5	—	69	M 60×2
1 1/2	12	33	5	35.5	53	—	56	24.5	5	—	78	M 68×2
2	13.5	37	5.5	39.5	65	—	69	27	5.5	—	93	M 82×2
2 1/2	15	42	6	45.5	81	—	86	29.5	6	—	112	M 100×2
3	17	47	6.5	50	95	—	99	32.5	6.5	—	127	M 115×2
4	21	58	7.5	60.5	121	—	127	39	7.5	—	158	M 145×2

● The available conical unions(C-1) include brass unions which have brass sheets embedded inside the union thread. (1/2~4)

CKe galvanized iron pipe fitting

Crosses (Cr)

Unit : mm

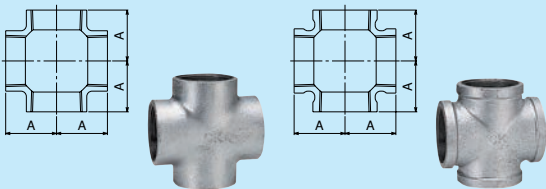

Fitting sizes	Face-to-centre dimensions
	A
1/4	19
3/8	23
● 1/2	27
● 3/4	32
● 1	38
● 1 1/4	46
● 1 1/2	48
● 2	57
2 1/2	69
3	78
4	97

Fittings having a nominal size of 2 1/2 or more are banded.
The banded products marked with "●" are produced on orders.

CKe galvanized iron pipe fitting

Reducing crosses (BRCr)

Unit : mm

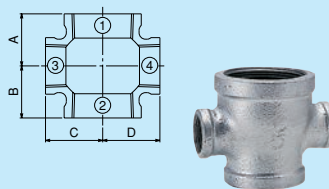

Fitting sizes ①×②×③×④	Face-to-centre dimensions				Fitting sizes ①×②×③×④	Face-to-centre dimensions			
	A	B	C	D		A	B	C	D
○ 1 x1 x 3/4 x 3/4	34	34	35	35	○ #2 1/2 x 2 1/2 x 3/4 x 3/4	44	44	58	58
○ #1 1/4 x 1 x 3/4 x 3/4	37	34	40	40	○ #2 1/2 x 2 x 1 x 1	48	44	60	60
○ #1 1/4 x 1 x 1 x 3/4	40	38	42	40	○ 2 1/2 x 2 1/2 x 1 x 1	48	48	60	60
○ #1 1/4 x 1 x 1 x 1	40	38	42	42	○ 2 1/2 x 2 1/2 x 2 x 2	60	60	65	65
○ 1 1/4 x 1 1/4 x 3/4 x 3/4	38	38	40	40	○ 3 x 3 x 2 x 2	62	62	72	72
○ #1 1/2 x 1 x 3/4 x 3/4	38	34	43	43					
○ #1 1/2 x 1 x 1 x 3/4	41	37	45	43					
○ #1 1/2 x 1 x 1 x 1	41	37	45	45					
○ #1 1/2 x 1 1/4 x 3/4 x 3/4	38	38	43	43					
○ #1 1/2 x 1 1/4 x 1 x 3/4	41	40	45	43					
○ #1 1/2 x 1 1/4 x 1 x 1	41	40	45	45					
○ 1 1/2 x 1 1/2 x 3/4 x 3/4	38	38	43	43					
○ 1 1/2 x 1 1/2 x 1 x 1	41	41	45	45					
○ #2 x 1 1/4 x 1 x 1	44	40	51	51					
○ #2 x 1 1/2 x 3/4 x 3/4	41	38	50	50					
○ #2 x 1 1/2 x 1 x 1	45	42	52	52					
○ #2 x 1 1/2 x 1 1/4 x 1	49	46	54	52					
○ 2 x 2 x 3/4 x 3/4	41	41	49	49					
○ 2 x 2 x 1 x 1	44	44	51	51					
○ #2 x 2 x 1 1/4 x 1	48	48	54	51					
○ 2 x 2 x 1 1/2 x 1 1/2	52	52	55	55					

Fittings marked ○ are banded.
Fittings marked ※ are not defined in the JIS standard.